

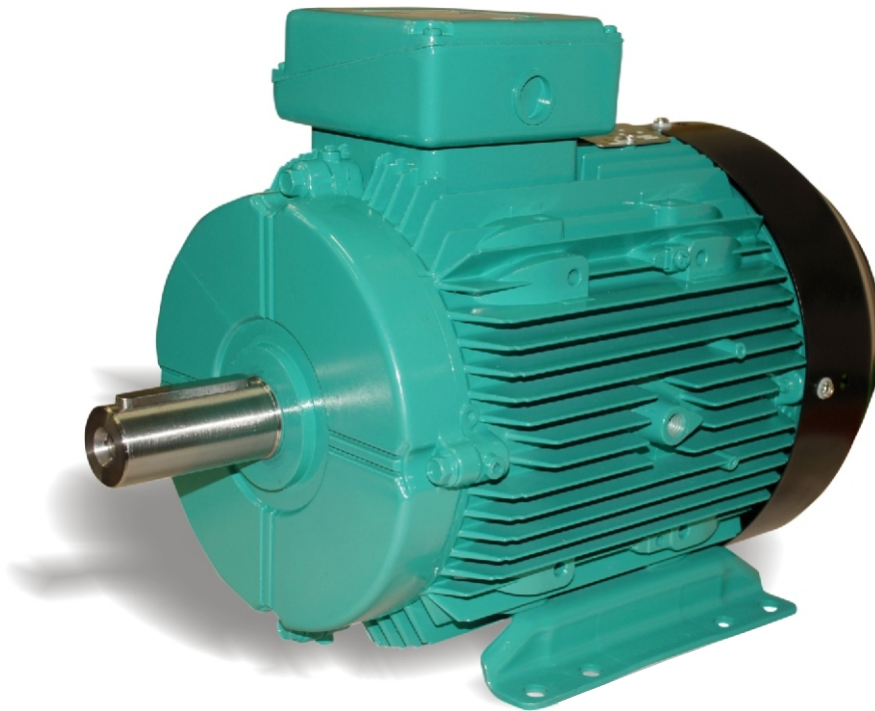

Smart solutions.
Strong relationships.

Low Voltage AC Motors

Efficiency class Eff-2



*We put all our energy
into saving yours !*



Crompton Greaves (CG) is part of the US\$ 4 bn Avantha Group ,a conglomerate with an impressive global footprint. Since its inception CG has been synonymous with electricity.

The company has retained its leadership position in the management and application of electrical energy.

Today ,Crompton Greaves is one of the largest private sector enterprises. It has diversified extensively and is engaged in designing ,manufacturing and marketing technologically advanced electrical product and services related to power generation ,transmission and distribution ,besides executing turnkey projects. The company is customer-centric in its focus and is the single largest source for a wide variety of electrical equipments and products.

CG employs more than 10000 people in 21 countries. With several international acquisitions. Crompton Greaves is fast emerging as a first choice global supplier for high quality equipment through its three business groups viz;

Power System: Transformer ,Switchgear ,Power Quality. Engineering Projects.

Industrial Systems: Motors ,Alternators,Drives,Railway Signaling,Stampings.

Consumer Products: Fans ,Appliances ,Lighting ,Integrated Security Solutions & Home Automation ,Pumps



AVANTHA
GROUP COMPANY



Crompton Greaves Ltd

As one of the world's leading engineering corporations, CG provides end-to-end solutions, helping its customers to use electrical power effectively and to increase industrial productivity with sustainability. CG was established in 1937 in India; and, since then the company has retained its leadership position in the management and application of electrical energy.

CG is leading manufacturer of electric motors, with motor solutions, which benefits a wide range of customers. Our products are used in almost every industrial application including general manufacturing, petrochemicals, food processing, pharmaceuticals where they drive fans, pumps, compressors, conveyors, lifts and cranes, amongst other things.

Our core competencies lie in our design facility conforming to the international quality standards. We make continuous effort, to bring out the latest, most advanced product into market-place. We continuously add many new services, features and introduce new solutions so as to ensure complete customer satisfaction.

Quality assurance

Stringent quality procedures are observed from first design to finished product in accordance with the ISO9001 documented quality systems. All of our factories have been assessed to meet these requirements, a further assurance that only the highest possible standards of quality are accepted.

Benefits

- High efficient at low running cost
- Low vibration and noise
- High torque with smooth acceleration
- Long service life; CG LV Induction Motors are designed and manufactured with carefully selected and tested insulating materials to ensure long services. The life of the motors mostly depends upon the life of insulating material.
- Motors can withstand the 1.5 rated current for 2 minutes without suffering damage. This feature makes the motor suitable for various applications.
- Low vibrations.
- VFD compatible*
- Super aesthetics.

Multi Mount

(Aluminium motor range upto 7.5 kW)- By simply changing the position of feet, user is able to convert right, left or top terminal box position and by changing the standard end shield user can change it for flange or face version.

REFERENCE STANDARDS

| Standards | Description |
|-------------------|--|
| IEC 60034-2004 | Rotating electrical machines - Rating & Performance |
| IEC 60034-6 | Rotating electrical machines - Cooling methods |
| IEC 60034-5:2006 | Rotating electrical machines - Degrees of protection |
| IEC 60034-9:2007 | Rotating electrical machines - Noise Limits |
| IEC 60034-14:2007 | Rotating electrical machines - Vibration Limits |
| IEC 60072-1:1991 | Rotating electrical machines - Dimensions and output |



* For more details on VFD compatibility please contact CG sales

IEC Eff-2 Aluminium motors (GD Frames)

| | |
|--------|--------------------|
| Range | |
| Output | 0.18 kW to 7.50 kW |
| Frames | GD 63 TO GD 132 |
| Poles | 2,4,6,8 |



| Specification | Standard Product | Option |
|-----------------------------|--|--------------------------------------|
| Frame sizes | 63 to 132 | - |
| Enclosure | IP55 | IP56, IP65 |
| Mounting option | Foot (B3) | Flange (B5), Face (B14) or Pad (B30) |
| Voltage | 3 kW and below: 400 V 4 kW and above: 400Δ | Others as per customer requirement |
| Frequency | 50 Hz | 60 Hz |
| Cooling | IC411 | IC410 |
| Lubrication | Frame 63 to 132 double-shielded bearings | - |
| Insulation | Class F | Class H |
| Temperature rise | Class B | Class F |
| Fan cover | MS | Plastic |
| Thermal protection | - | 80 to 132 frames |
| Anti condensation heaters | - | - |
| | | 132 frame |
| Inverter Duty (with derate) | Variable Torque - 10:1, Constant Torque - 2:1 | Alternative speed range |
| Ambient temperature | - 20°C to + 40°C | Higher than 50°C |
| DC brake | - | 80 to 132 frames |
| Altitude | ≤ 1000m | Higher than 1000 m |

The above specification and options give a brief summary of features available for aluminium range.
For a full listing of optional features, please contact CG sales



IEC Eff-2 cast Iron motors.(ND Frames)

| Range | |
|--------|-------------------------------------|
| Output | 0.18 kW to 315 kW |
| Frames | ND80 to ND132M ND160M to ND355LX |
| Poles | 2,4,6,8 |



| Specification | Standard Product | | Option |
|-----------------------------|--|-----------|--|
| | Frame sizes | 80 to 355 | - |
| Enclosure | IP55 | - | IP56 |
| Mounting option | Foot (B3) mounting feet integral with the Stator body | - | Flange (B5) ,Face (B14) - upto 132 Frame |
| Voltage | 3 kW and below: 400 Δ 4 kW and above: 400 Δ | - | Others as per customer requirement |
| Frequency | 50 Hz | - | 60 Hz |
| Cooling | IC411 | - | IC410 |
| Lubrication | Frame 80 to 225 double-shielded bearings Frame 250 to 355 online Greasing | - | 160 To 225 Online Greasing |
| Insulation | Class F | - | Class H |
| Temperature rise | Class B | - | Class F |
| Fan cover | MS Steel | - | - |
| Thermal protection | - | - | 80 to 355 frame |
| Anti condensation Heaters | - | - | 160 to 355 frame |
| Inverter Duty (with derate) | Variable Torque - 10:1, Constant Torque - 2:1 (for frame 80 to 132) | - | Alternative speed range |
| Ambient temperature | - 20°C to + 40°C | - | Higher than 50°C; Less than -20°C |
| DC brake | - | - | 80 to 200 frame |
| Altitude | \leq 1000m | - | Higher than 1000 m |

The above specification and options give a brief summary of features available for cast iron range.
For a full listing of optional features, please contact CG sales

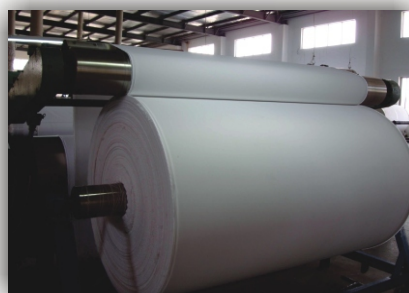
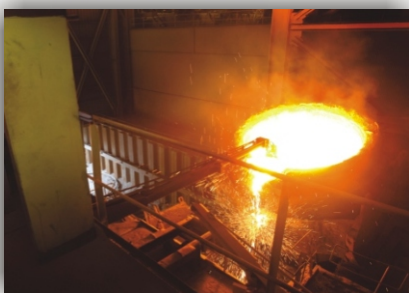

TEFC 3 PHASE FOOT MOUNTED ALUMINIUM INDUCTION MOTORS

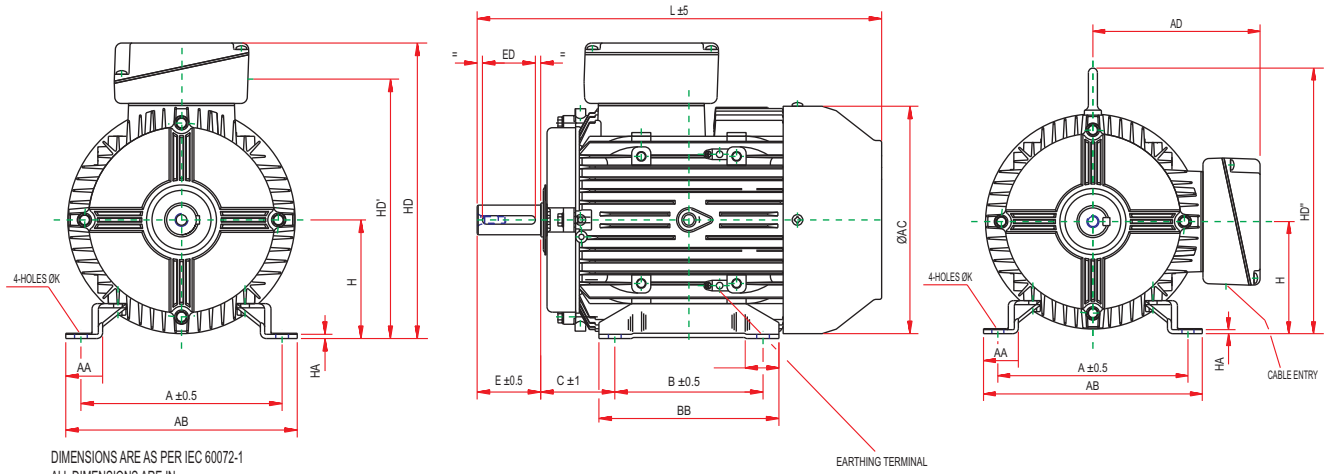

DIMENSIONS ARE AS PER IEC 60072-1
ALL DIMENSIONS ARE IN mm.

| General | | | | | | | | | | | | | Terminalbox | | | |
|---------|-----|-----|----|-----|----|-----|----|-----|-----|-----|----|-----|-----------------|-----|-----|----|
| Type | A | B | C | H | K | L | AA | AB | AC | BB | HA | HD | HD ¹ | TBW | TBH | KK |
| GD63 | 100 | 80 | 40 | 63 | 7 | 207 | 19 | 119 | 126 | 100 | 2 | 163 | 138 | 86 | 86 | 20 |
| GD71S | 112 | 90 | 45 | 71 | 7 | 238 | 19 | 131 | 140 | 110 | 2 | 186 | 162 | 86 | 86 | 20 |
| GD80 | 125 | 100 | 50 | 80 | 10 | 278 | 27 | 157 | 160 | 127 | 4 | 212 | 183 | 86 | 86 | 20 |
| GD90S | 140 | 100 | 56 | 90 | 10 | 322 | 28 | 164 | 178 | 150 | 4 | 225 | 201 | 86 | 86 | 20 |
| GD90L | 140 | 125 | 56 | 90 | 10 | 322 | 28 | 164 | 178 | 150 | 4 | 225 | 201 | 86 | 86 | 20 |
| GD100L | 160 | 140 | 63 | 100 | 12 | 368 | 28 | 184 | 199 | 170 | 4 | 254 | 223 | 106 | 106 | 20 |
| GD112M | 190 | 140 | 70 | 112 | 12 | 382 | 35 | 218 | 215 | 170 | 4 | 279 | 245 | 127 | 127 | 25 |
| GD132S | 216 | 140 | 89 | 132 | 12 | 451 | 38 | 242 | 255 | 208 | 5 | 320 | 287 | 127 | 127 | 25 |
| GD132M | 216 | 178 | 89 | 132 | 12 | 451 | 38 | 242 | 255 | 208 | 5 | 320 | 287 | 127 | 127 | 25 |

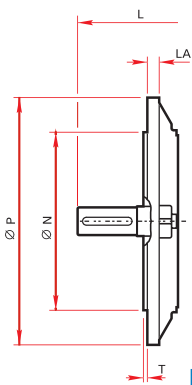

FLANGE MOUNTING IM - B5

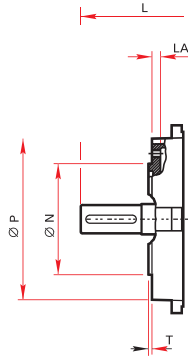

FACE MOUNTING IM - B14

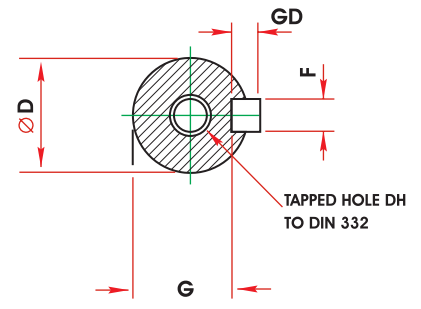

SHAFT DIA

| IM B5 MOUNTING | | | | | | | IM B14 MOUNTING | | | | | | SHAFT DIMENSIONS | | | | | | |
|----------------|-----|-----|-----|------|-----|----|-----------------|-----|-----|-----|-----|----|------------------|----|----|----|------|----|---------|
| TYPE | M | N | P | S | T | LA | M | N | P | S | T | LA | TYPE | D | E | F | G | ED | DH |
| GD63 | 115 | 95 | 140 | 10 | 3.0 | 7 | 75 | 60 | 90 | M5 | 2.5 | 7 | GD80 | 11 | 23 | 4 | 8.5 | 10 | M4X10 |
| GD71S | 130 | 110 | 160 | 10 | 3.5 | 7 | 85 | 70 | 105 | M6 | 2.5 | 9 | GD90S/L | 14 | 30 | 5 | 11 | 20 | M5X12.5 |
| GD80 | 165 | 130 | 200 | 12 | 3.5 | 12 | 100 | 80 | 120 | M6 | 3 | 9 | GD80 | 19 | 40 | 6 | 15.5 | 32 | M6X16 |
| GD90S/L | 165 | 130 | 200 | 12 | 3.5 | 10 | 115 | 95 | 140 | M8 | 3 | 9 | GD90S/L | 24 | 50 | 8 | 20 | 40 | M8X19 |
| GD100L | 215 | 180 | 250 | 14.5 | 4 | 12 | 130 | 110 | 160 | M8 | 3.5 | 12 | GD100L | 28 | 60 | 8 | 24 | 50 | M10X22 |
| GD112M | 215 | 180 | 250 | 14.5 | 4 | 12 | 130 | 110 | 164 | M8 | 3.5 | 13 | GD112M | 28 | 60 | 8 | 24 | 50 | M10X22 |
| GD132S/M | 265 | 230 | 300 | 14.5 | 4 | 14 | 165 | 130 | 200 | M10 | 3.5 | 13 | GD132S/M | 38 | 80 | 10 | 33 | 70 | M12X28 |

* Some features may be different and may not be a part of standard product.

TEFC, 3 PHASE FOOT MOUNTED CAST IRON INDUCTION MOTORS (ND80 to ND132)

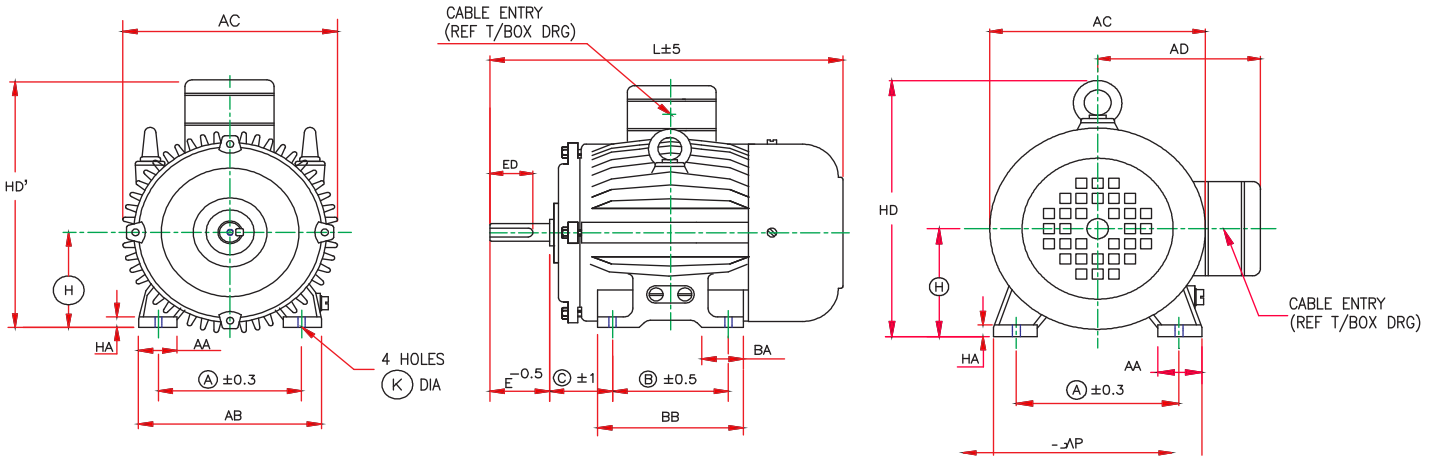

| TYPE | A | B | C | H | K | L | AA | AB | AC | BB | HA | HD | BA | AD | HD' |
|--------|-----|-----|----|-----|----|-----|----|-----|-----|-----|----|-----|----|-----|-----|
| ND80 | 125 | 100 | 50 | 80 | 10 | 285 | 35 | 152 | 170 | 124 | 11 | 165 | 45 | 134 | 225 |
| ND90S | 140 | 100 | 56 | 90 | 10 | 310 | 35 | 168 | 190 | 127 | 13 | 185 | 40 | 150 | 240 |
| ND90L | 140 | 125 | 56 | 90 | 10 | 335 | 35 | 168 | 190 | 152 | 13 | 185 | 40 | 150 | 240 |
| ND100L | 160 | 140 | 63 | 100 | 12 | 380 | 36 | 192 | 210 | 170 | 13 | 250 | 45 | 160 | 260 |
| ND112M | 190 | 140 | 70 | 112 | 12 | 405 | 36 | 222 | 230 | 170 | 13 | 275 | 50 | 170 | 320 |
| ND132S | 216 | 140 | 89 | 132 | 12 | 470 | 48 | 254 | 270 | 178 | 16 | 320 | 54 | 190 | 360 |
| ND132M | 216 | 178 | 89 | 132 | 12 | 510 | 48 | 254 | 275 | 216 | 16 | 320 | 54 | 190 | 360 |

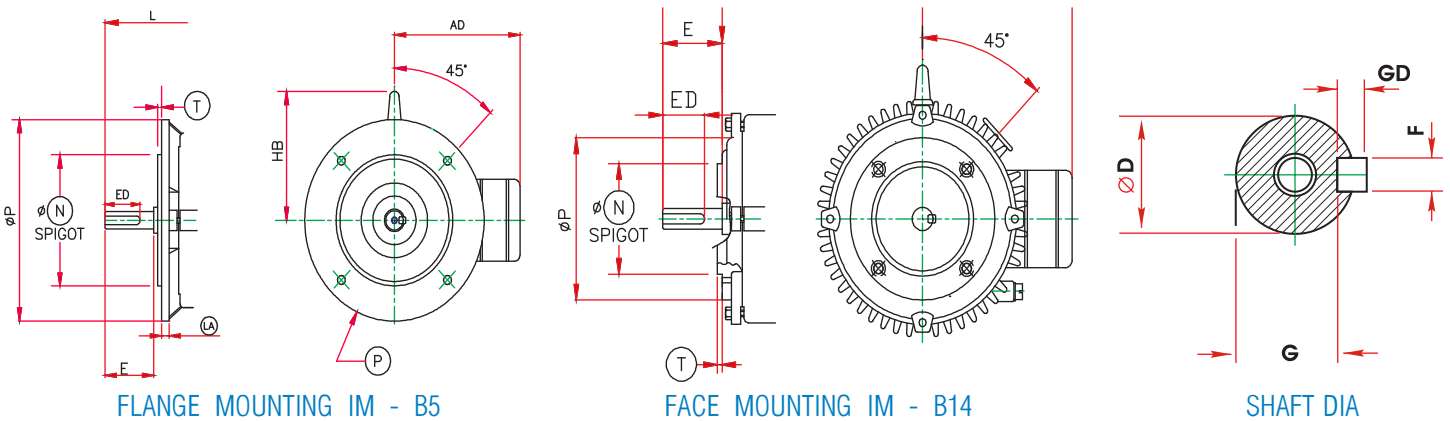

FLANGE MOUNTING IM - B5

FACE MOUNTING IM - B14

SHAFT DIA

| IM B5 MOUNTING | | | | | | | IM B14 MOUNTING | | | | | | SHAFT DIMENSIONS | | | | | | |
|----------------|-----|-----|-----|----|-----|----|-----------------|-----|-----|-----|-----|----|------------------|-----------|----|----|------|----|--------|
| TYPE | M | N | P | S | T | LA | M | N | P | S | T | LA | TYPE | D | E | F | G | ED | Y |
| ND80 | 165 | 130 | 200 | 12 | 3.5 | 10 | 100 | 80 | 120 | M6 | 3 | - | ND80 | 19.0/18.9 | 40 | 6 | 15.5 | 27 | M6X16 |
| ND90S/L | 165 | 130 | 200 | 12 | 3.5 | 10 | 115 | 95 | 140 | M8 | 3 | 10 | ND90S/L | 24.0/23.9 | 50 | 8 | 20 | 36 | M8X19 |
| ND100L | 215 | 180 | 250 | 15 | 4 | 11 | 130 | 110 | 160 | M8 | 3.5 | 11 | ND100L | 28.0/27.9 | 60 | 8 | 24 | 44 | M10X22 |
| ND112M | 215 | 180 | 250 | 15 | 4 | 11 | 130 | 110 | 160 | M8 | 3.5 | 11 | ND112M | 28.0/27.9 | 80 | 8 | 24 | 44 | M10X22 |
| ND132S/M | 265 | 230 | 300 | 15 | 4 | 14 | 165 | 130 | 200 | M10 | 3.5 | 12 | ND132S/M | 38.0/37.9 | 80 | 10 | 33 | 60 | M12X28 |

* Some features may be different and may not be a part of standard product.

TEFC, 3 PHASE FOOT MOUNTED CAST IRON INDUCTION MOTORS

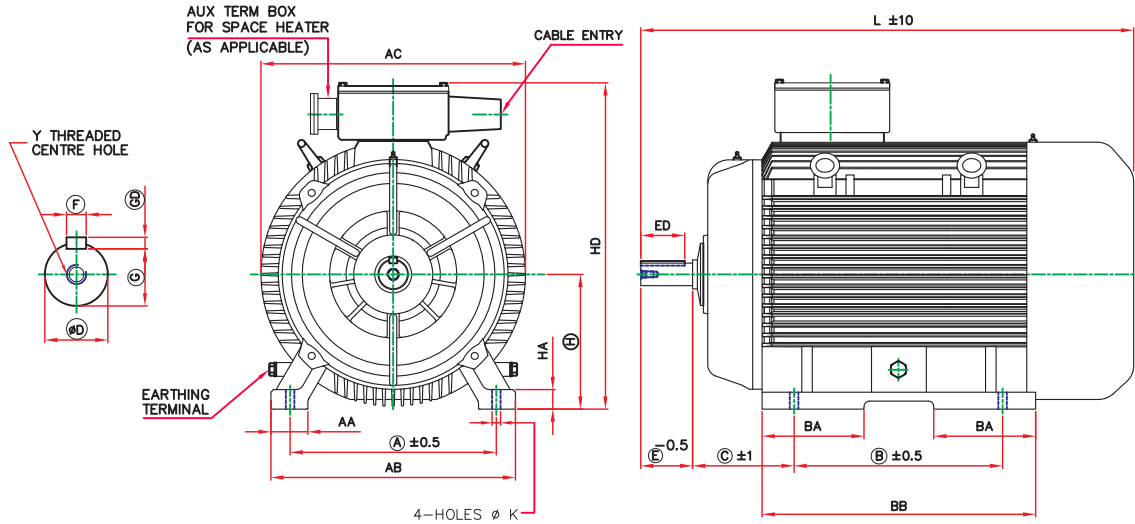

RINGED DIMENSIONS ARE AS PER IEC:60072-1
ALL DIMENSIONS ARE IN mm

| Frame | A | B | C | H | AA | AB | BA | BB | K | D | E | ED | F | GD | G | Y | AC | L | HD | HA |
|---------------------|-----|-----|-----|---------------|-----|-----|-----|-----|-------------|------------------|-----|-----|----------------|---------------|-------------|--------|-----|------|-----|----|
| POLE :2, 4,6 | | | | | | | | | | | | | | | | | | | | |
| ND160M | 254 | 210 | 108 | 160.0 / 159.5 | 73 | 308 | 76 | 254 | 15.5 / 15.0 | 42.018/ 42.002 | 110 | 80 | 12.00 / 11.957 | 8.00 / 7.91 | 37.0 / 36.8 | M16X32 | 318 | 605 | 435 | 22 |
| ND160L | 254 | 254 | 108 | 160.0 / 159.5 | 73 | 308 | 101 | 298 | 15.5 / 15.0 | 42.018/ 42.002 | 110 | 80 | 12.00 / 11.957 | 8.00 / 7.91 | 37.0 / 36.8 | M16X32 | 318 | 650 | 435 | 22 |
| ND180M | 279 | 241 | 121 | 180 / 179.5 | 84 | 348 | 85 | 286 | 15.5 / 15.0 | 48.018/ 48.002 | 110 | 80 | 14.00 / 13.957 | 9.00 / 8.91 | 42.5 / 42.3 | M16X32 | 352 | 677 | 475 | 22 |
| ND180L | 279 | 279 | 121 | 180 / 179.5 | 84 | 348 | 106 | 323 | 15.5 / 15.0 | 48.018/ 48.002 | 110 | 80 | 14.00 / 13.957 | 9.00 / 8.91 | 42.5 / 42.3 | M16X32 | 352 | 715 | 475 | 22 |
| ND200L | 318 | 305 | 133 | 200.0 / 199.5 | 66 | 381 | 115 | 356 | 19.5 / 19.0 | 55.030/ 55.011 | 110 | 80 | 16.00 / 15.957 | 10.00 / 9.91 | 49.0 / 48.8 | M20X40 | 428 | 790 | 545 | 25 |
| POLE : 4,6 | | | | | | | | | | | | | | | | | | | | |
| ND225S | 356 | 286 | 149 | 225.0 / 224.5 | 70 | 425 | 102 | 340 | 19.5 / 19.0 | 60.030/ 60.011 | 140 | 110 | 18.00 / 17.957 | 11.00 / 10.91 | 53.0 / 52.8 | M20X40 | 470 | 840 | 600 | 25 |
| ND225M | 356 | 311 | 149 | 225.0 / 224.5 | 70 | 425 | 102 | 375 | 19.5 / 19.0 | 60.030/ 60.011 | 140 | 110 | 18.00 / 17.957 | 11.00 / 10.91 | 53.0 / 52.8 | M20X40 | 470 | 865 | 600 | 25 |
| ND250S | 406 | 311 | 168 | 250.0 / 249.5 | 80 | 483 | 140 | 419 | 24.5 / 24.0 | 65.030/ 65.011 | 140 | 110 | 18.00 / 17.957 | 11.00 / 10.91 | 58.0 / 57.8 | M20X40 | 500 | 940 | 730 | 32 |
| ND250MX | 406 | 349 | 168 | 250.0 / 249.5 | 80 | 483 | 140 | 419 | 24.5 / 24.0 | 65.030/ 65.011 | 140 | 110 | 18.00 / 17.957 | 11.00 / 10.91 | 58.0 / 57.8 | M20X40 | 500 | 970 | 730 | 32 |
| ND280S | 457 | 368 | 190 | 280.0 / 279.0 | 100 | 538 | 137 | 440 | 24.5 / 24.0 | 75.030/ 75.011 | 140 | 110 | 20.00 / 19.948 | 12.00 / 11.91 | 67.5 / 67.3 | M20X40 | 536 | 1035 | 810 | 35 |
| ND280M | 457 | 419 | 190 | 280.0 / 279.0 | 100 | 538 | 162 | 487 | 24.5 / 24.0 | 75.030/ 75.011 | 140 | 110 | 20.00 / 19.948 | 12.00 / 11.91 | 67.5 / 67.3 | M20X40 | 536 | 1085 | 810 | 35 |
| ND315S | 508 | 406 | 216 | 315.0 / 314.0 | 110 | 597 | 138 | 485 | 28.5 / 28.0 | 80.030/ 80.011 | 170 | 140 | 22.00 / 21.948 | 14.00 / 13.91 | 71.0 / 70.8 | M20X40 | 590 | 1180 | 845 | 35 |
| ND315M | 508 | 457 | 216 | 315.0 / 314.0 | 110 | 597 | 164 | 533 | 28.5 / 28.0 | 80.030/ 80.011 | 170 | 140 | 22.00 / 21.948 | 14.00 / 13.91 | 71.0 / 70.8 | M20X40 | 590 | 1230 | 845 | 35 |
| ND315L | 508 | 508 | 216 | 315.0 / 314.0 | 110 | 610 | 204 | 655 | 28.5 / 28.0 | 90.035/ 90.013 | 170 | 140 | 25.00 / 24.948 | 14.00 / 13.91 | 81.0 / 80.8 | M24X50 | 655 | 1295 | 885 | 38 |
| ND315LX | 508 | 508 | 216 | 315.0 / 314.0 | 110 | 610 | 235 | 740 | 28.5 / 28.0 | 90.035/ 90.013 | 170 | 140 | 25.00 / 24.948 | 14.00 / 13.91 | 81.0 / 80.8 | M24X50 | 655 | 1390 | 885 | 38 |
| ND355S | 610 | 510 | 254 | 355.0 / 354.0 | 110 | 710 | 253 | 745 | 28.5 / 28.0 | 100.035/ 100.013 | 210 | 160 | 28.00 / 27.948 | 16.00 / 15.89 | 90.0 / 89.8 | M24X50 | 672 | 1513 | 950 | 40 |
| ND355M | 610 | 560 | 254 | 355.0 / 354.0 | 110 | 710 | 253 | 745 | 28.5 / 28.0 | 100.035/ 100.013 | 210 | 160 | 28.00 / 27.948 | 16.00 / 15.89 | 90.0 / 89.8 | M24X50 | 672 | 1513 | 950 | 40 |
| ND355L | 610 | 630 | 254 | 355.0 / 354.0 | 110 | 710 | 253 | 745 | 28.5 / 28.0 | 100.035/ 100.013 | 210 | 160 | 28.00 / 27.948 | 16.00 / 15.89 | 90.0 / 89.8 | M24X50 | 672 | 1513 | 950 | 40 |

* Some features may be different and may not be a part of standard product.

TEFC, 3 PHASE FOOT MOUNTED CAST IRON INDUCTION MOTORS

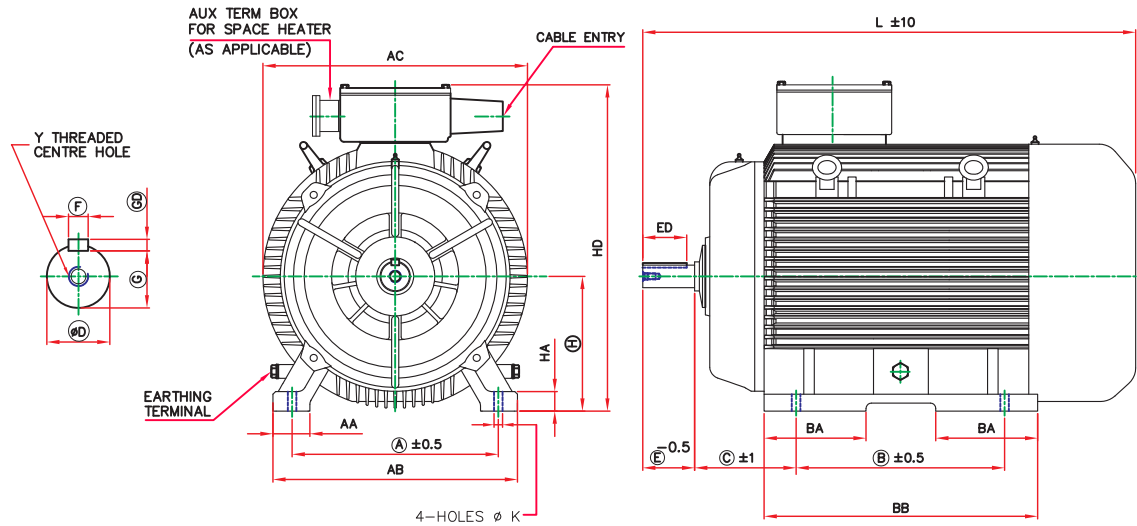

RINGED DIMENSIONS ARE AS PER IEC:60072-1
ALL DIMENSIONS ARE IN mm

| Frame | A | B | C | H | AA | AB | BA | BB | K | D | E | ED | F | GD | G | Y | AC | L | HD | HA |
|---------|-----|-----|-----|---------------|-----|-----|-----|-----|-------------|-----------------|-----|-----|----------------|---------------|-------------|--------|-----|------|-----|----|
| ND225S | 356 | 286 | 149 | 225.0 / 224.5 | 70 | 425 | 102 | 340 | 19.5 / 19.0 | 55.030 / 55.011 | 110 | 80 | 16.00 / 15.957 | 10.00 / 9.91 | 49.0 / 48.8 | M20X40 | 470 | 810 | 600 | 25 |
| ND225M | 356 | 311 | 149 | 225.0 / 224.5 | 70 | 425 | 102 | 375 | 19.5 / 19.0 | 55.030 / 55.011 | 110 | 80 | 16.00 / 15.957 | 10.00 / 9.91 | 49.0 / 48.8 | M20X40 | 470 | 825 | 600 | 25 |
| ND250S | 406 | 311 | 168 | 250.0 / 249.5 | 80 | 483 | 140 | 419 | 24.5 / 24.0 | 60.030 / 60.011 | 140 | 110 | 18.00 / 17.957 | 11.00 / 10.91 | 53.0 / 52.8 | M20X40 | 500 | 940 | 730 | 32 |
| ND250MX | 406 | 349 | 168 | 250.0 / 249.5 | 80 | 483 | 140 | 419 | 24.5 / 24.0 | 60.030 / 60.011 | 140 | 110 | 18.00 / 17.957 | 11.00 / 10.91 | 53.0 / 52.8 | M20X40 | 500 | 970 | 730 | 32 |
| ND280S | 457 | 368 | 190 | 280.0 / 279.0 | 100 | 538 | 137 | 440 | 24.5 / 24.0 | 65.030 / 65.011 | 140 | 110 | 18.00 / 17.957 | 11.00 / 10.91 | 58.0 / 57.8 | M20X40 | 536 | 1035 | 810 | 35 |
| ND280M | 457 | 419 | 190 | 280.0 / 279.0 | 100 | 538 | 162 | 487 | 24.5 / 24.0 | 65.030 / 65.011 | 140 | 110 | 18.00 / 17.957 | 11.00 / 10.91 | 58.0 / 57.8 | M20X40 | 536 | 1085 | 810 | 35 |
| ND315S | 508 | 406 | 216 | 315.0 / 314.0 | 110 | 597 | 138 | 485 | 28.5 / 28.0 | 70.030 / 70.011 | 140 | 110 | 20.00 / 19.948 | 12.00 / 11.91 | 62.5 / 62.3 | M20X40 | 655 | 1265 | 885 | 38 |
| ND315M | 508 | 457 | 216 | 315.0 / 314.0 | 110 | 597 | 164 | 533 | 28.5 / 28.0 | 70.030 / 70.011 | 140 | 110 | 20.00 / 19.948 | 12.00 / 11.91 | 62.5 / 62.3 | M20X40 | 655 | 1360 | 885 | 38 |
| ND315L | 508 | 508 | 216 | 315.0 / 314.0 | 110 | 610 | 204 | 655 | 28.5 / 28.0 | 70.030 / 70.011 | 140 | 110 | 20.00 / 19.948 | 12.00 / 11.91 | 62.5 / 62.3 | M20X40 | 655 | 1360 | 885 | 38 |
| ND315LX | 508 | 508 | 216 | 315.0 / 314.0 | 110 | 610 | 235 | 740 | 28.5 / 28.0 | 70.030 / 70.011 | 140 | 110 | 20.00 / 19.948 | 12.00 / 11.91 | 62.5 / 62.3 | M20X40 | 655 | 1360 | 885 | 38 |
| ND355S | 610 | 510 | 254 | 355.0 / 354.0 | 110 | 710 | 253 | 745 | 28.5 / 28.0 | 75.030 / 75.011 | 170 | 140 | 20.00 / 19.948 | 12.00 / 11.91 | 67.5 / 67.3 | M20X40 | 672 | 1473 | 950 | 40 |
| ND355M | 610 | 560 | 254 | 355.0 / 354.0 | 110 | 710 | 253 | 745 | 28.5 / 28.0 | 75.030 / 75.011 | 170 | 140 | 20.00 / 19.948 | 12.00 / 11.91 | 67.5 / 67.3 | M20X40 | 672 | 1473 | 950 | 40 |
| ND355L | 610 | 630 | 254 | 355.0 / 354.0 | 110 | 710 | 253 | 745 | 28.5 / 28.0 | 75.030 / 75.011 | 170 | 140 | 20.00 / 19.948 | 12.00 / 11.91 | 67.5 / 67.3 | M20X40 | 672 | 1473 | 950 | 40 |

* Some features may be different and may not be a part of standard product.

TEFC, 3 PHASE FOOT MOUNTED CAST IRON INDUCTION MOTORS (FRAME ND355LX)

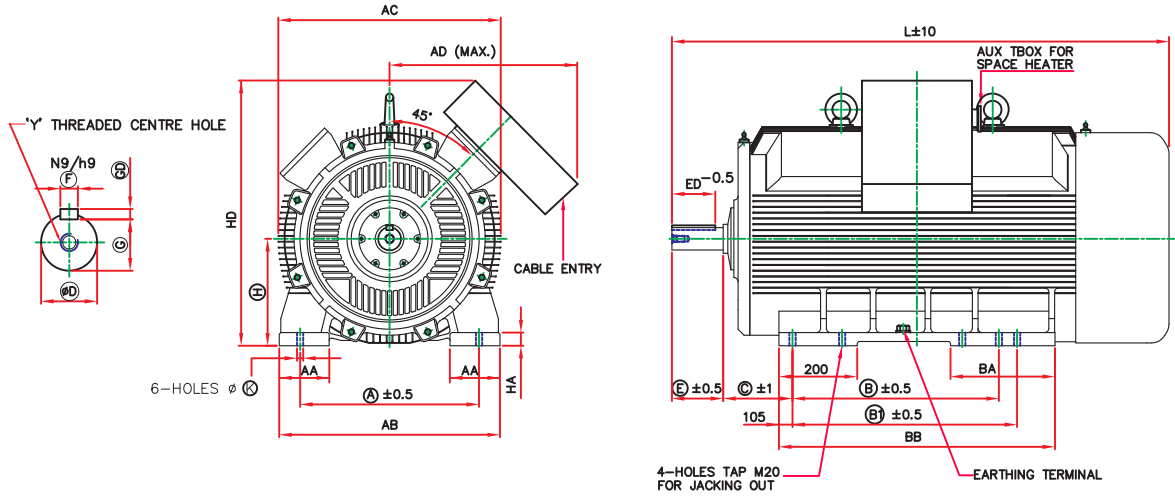

RINGED DIMENSIONS ARE AS PER IEC:60072-1
ALL DIMENSIONS ARE IN mm

| Frame | A | B | C | H | AA | AB | BA | BB | K | D | E | ED | F | GD | G | Y | AD | AC | L | HD | HA |
|------------------|-----|-----|-----|---------------|-----|-----|-----|-----|-------------|-------------------|-----|-----|----------------|---------------|-------------|--------|-----|-----|------|-----|----|
| POLE :2 | | | | | | | | | | | | | | | | | | | | | |
| ND355LX | 610 | 630 | 254 | 355.0 / 354.0 | 110 | 710 | 250 | 850 | 28.5 / 28.0 | 75.030 / 75.011 | 170 | 140 | 20.00 / 19.948 | 12.00 / 11.91 | 67.5 / 67.3 | M20X40 | 720 | 720 | 1540 | 950 | 40 |
| POLE :4,6 | | | | | | | | | | | | | | | | | | | | | |
| ND355LX | 610 | 630 | 254 | 355.0 / 354.0 | 110 | 710 | 250 | 850 | 28.5 / 28.0 | 100.035 / 100.013 | 210 | 160 | 28.00 / 27.948 | 16.00 / 15.89 | 90.0 / 89.8 | M24x50 | 720 | 720 | 1580 | 950 | 40 |

* Some features may be different and may not be a part of standard product.

TEFC, 3 PHASE FLANGE MOUNTED CAST IRON INDUCTION MOTORS

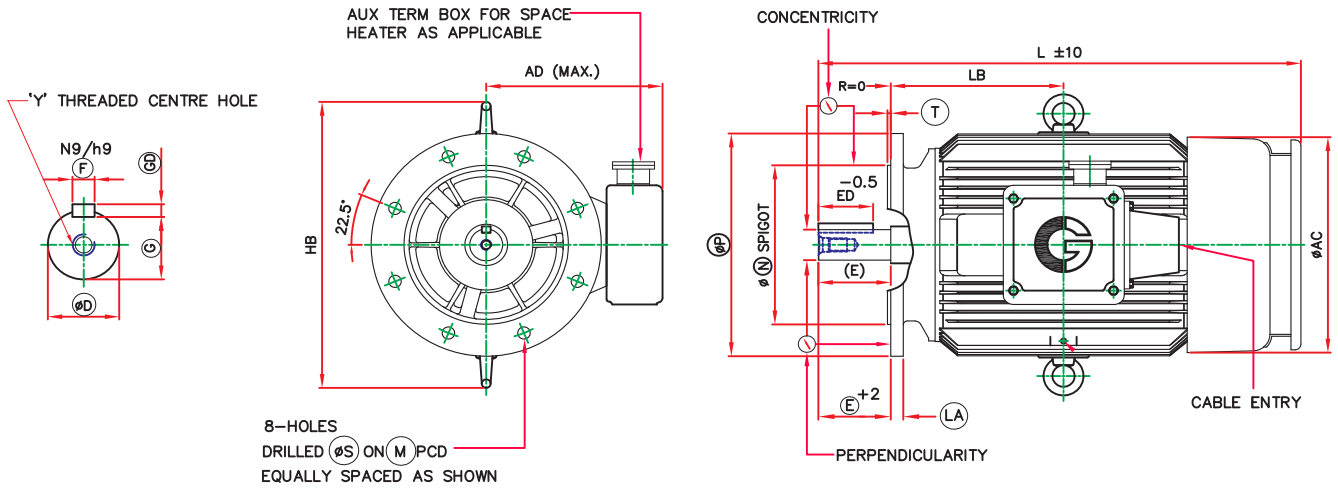

RINGED DIMENSIONS ARE AS PER IEC:60072-1
ALL DIMENSIONS ARE IN mm

| Frame | D | E | ED | F | GD | G | Y | AD | AC | L | MTol | NTol | P | S | T | LA | LB | HB |
|----------------|-------------------|-----|-----|----------------|---------------|-------------|--------|-----|-----|------|---------------|-------------------|-----|----|---|----|-----|-----|
| POLE : 2, 4, 6 | | | | | | | | | | | | | | | | | | |
| ND160M | 42.018 / 42.002 | 110 | 80 | 12.00 / 11.957 | 8.00 / 7.91 | 37.0 / 36.8 | M16X32 | 325 | 318 | 660 | 300.5 / 299.5 | 250.016 / 249.987 | 350 | 19 | 5 | 18 | 213 | 421 |
| ND160L | 42.018 / 42.002 | 110 | 80 | 12.00 / 11.957 | 8.00 / 7.91 | 37.0 / 36.8 | M16X32 | 325 | 318 | 705 | 300.5 / 299.5 | 250.016 / 249.987 | 350 | 19 | 5 | 18 | 235 | 421 |
| ND180M | 48.018 / 48.002 | 110 | 80 | 14.00 / 13.957 | 9.00 / 8.91 | 42.5 / 42.3 | M16X32 | 345 | 352 | 750 | 300.5 / 299.5 | 250.016 / 249.987 | 350 | 19 | 5 | 18 | 242 | 478 |
| ND180L | 48.018 / 48.002 | 110 | 80 | 14.00 / 13.957 | 9.00 / 8.91 | 42.5 / 42.3 | M16X32 | 345 | 352 | 790 | 300.5 / 299.5 | 250.016 / 249.987 | 350 | 19 | 5 | 18 | 260 | 478 |
| ND200L | 55.030 / 55.011 | 110 | 80 | 16.00 / 15.957 | 10.00 / 9.91 | 49.0 / 48.8 | M20X40 | 430 | 428 | 830 | 350.5 / 349.5 | 300.018 / 299.982 | 400 | 19 | 5 | 18 | 285 | 557 |
| POLE : 4, 6 | | | | | | | | | | | | | | | | | | |
| ND225S | 60.030 / 60.011 | 140 | 110 | 18.00 / 17.957 | 11.00 / 10.91 | 53.0 / 52.8 | M20X40 | 455 | 470 | 895 | 400.5 / 399.5 | 350.018 / 349.982 | 450 | 19 | 5 | 19 | 305 | 618 |
| ND225M | 60.030 / 60.011 | 140 | 110 | 18.00 / 17.957 | 11.00 / 10.91 | 53.0 / 52.8 | M20X40 | 455 | 470 | 895 | 400.5 / 399.5 | 350.018 / 349.982 | 450 | 19 | 5 | 19 | 305 | 618 |
| ND250S | 65.030 / 65.011 | 140 | 110 | 18.00 / 17.957 | 11.00 / 10.91 | 58.0 / 57.8 | M20X40 | 485 | 500 | 1020 | 500.5 / 499.5 | 450.020 / 449.980 | 550 | 19 | 5 | 22 | 342 | 688 |
| ND250MX | 60.030 / 60.011 | 140 | 110 | 18.00 / 17.957 | 11.00 / 10.91 | 58.0 / 57.8 | M20X40 | 485 | 500 | 1050 | 500.5 / 499.5 | 450.020 / 449.980 | 550 | 19 | 5 | 22 | 342 | 688 |
| ND280S | 75.030 / 75.011 | 140 | 110 | 20.00 / 19.948 | 12.00 / 11.91 | 67.5 / 67.3 | M20X40 | 530 | 536 | 1170 | 500.5 / 499.5 | 450.020 / 449.980 | 550 | 19 | 5 | 22 | 400 | 722 |
| ND280M | 75.030 / 75.011 | 140 | 110 | 20.00 / 19.948 | 12.00 / 11.91 | 67.5 / 67.3 | M20X40 | 530 | 536 | 1170 | 500.5 / 499.5 | 450.020 / 449.980 | 550 | 19 | 5 | 22 | 400 | 722 |
| ND315S | 80.030 / 80.011 | 170 | 140 | 22.00 / 21.948 | 14.00 / 13.91 | 71.0 / 70.8 | M20X40 | 530 | 590 | 1325 | 601.0 / 599.0 | 550.022 / 549.978 | 660 | 24 | 6 | 25 | 445 | 812 |
| ND315M | 80.030 / 80.011 | 170 | 140 | 22.00 / 21.948 | 14.00 / 13.91 | 71.0 / 70.8 | M20X40 | 530 | 590 | 1325 | 601.0 / 599.0 | 550.022 / 549.978 | 660 | 24 | 6 | 25 | 445 | 812 |
| ND315L | 90.035 / 90.013 | 170 | 140 | 25.00 / 24.948 | 14.00 / 13.91 | 81.0 / 80.8 | M24X50 | 570 | 655 | 1495 | 601.0 / 599.0 | 550.022 / 549.978 | 660 | 24 | 6 | 25 | 531 | 880 |
| ND315LX | 90.035 / 90.013 | 170 | 140 | 25.00 / 24.948 | 14.00 / 13.91 | 81.0 / 80.8 | M24X50 | 570 | 655 | 1495 | 601.0 / 599.0 | 550.022 / 549.978 | 660 | 24 | 6 | 25 | 531 | 880 |
| ND355S | 100.035 / 100.013 | 210 | 160 | 28.00 / 27.948 | 16.00 / 15.89 | 90.0 / 89.8 | M24X50 | 570 | 672 | 1650 | 741.0 / 739.0 | 680.025 / 679.975 | 800 | 24 | 6 | 28 | 570 | 900 |
| ND355M | 100.035 / 100.013 | 210 | 160 | 28.00 / 27.948 | 16.00 / 15.89 | 90.0 / 89.8 | M24X50 | 570 | 672 | 1650 | 741.0 / 739.0 | 680.025 / 679.975 | 800 | 24 | 6 | 28 | 570 | 900 |
| ND355L | 100.035 / 100.013 | 210 | 160 | 28.00 / 27.948 | 16.00 / 15.89 | 90.0 / 89.8 | M24X50 | 570 | 672 | 1650 | 741.0 / 739.0 | 680.025 / 679.975 | 800 | 24 | 6 | 28 | 570 | 900 |

* Some features may be different and may not be a part of standard product.

TEFC, 3 PHASE FLANGE MOUNTED CAST IRON INDUCTION MOTORS

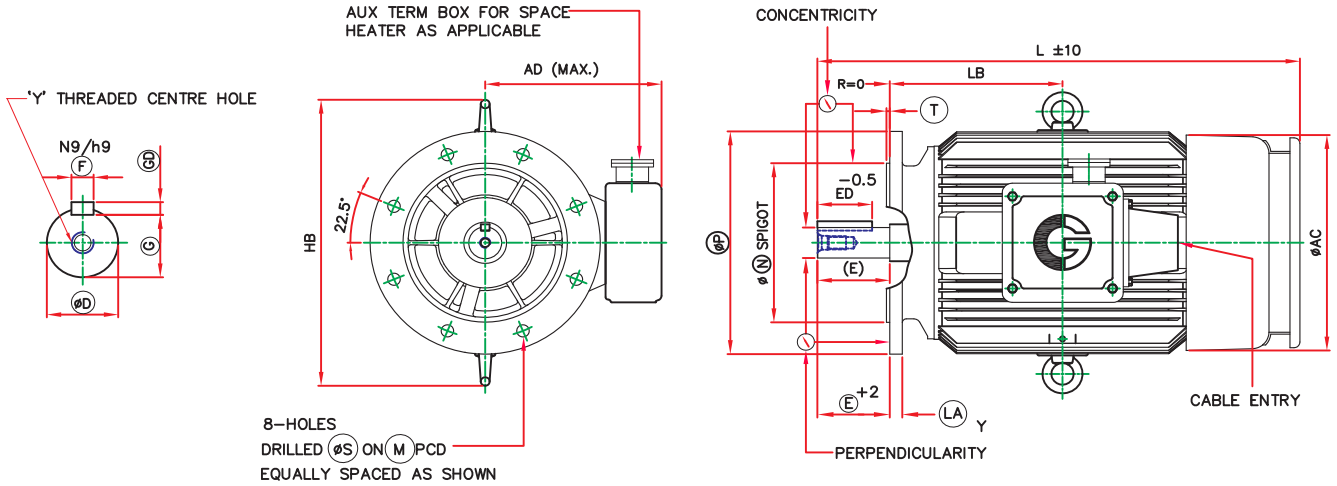

RINGED DIMENSIONS ARE AS PER IEC:60072-1
ALL DIMENSIONS ARE IN mm

| Frame | D | E | ED | F | GD | G | Y | AD | AC | L | MTol | NTol | P | S | T | LA | LB | HB |
|---------|-----------------|-----|-----|----------------|---------------|-------------|--------|-----|-----|------|---------------|-------------------|-----|----|---|----|-----|-----|
| POLE :2 | | | | | | | | | | | | | | | | | | |
| ND225S | 55.030 / 55.011 | 110 | 80 | 16.00 / 15.957 | 10.0 / 9.91 | 49.0 / 48.8 | M20X40 | 455 | 470 | 865 | 400.5 / 399.5 | 350.018 / 349.982 | 450 | 19 | 5 | 19 | 305 | 618 |
| ND225M | 55.030 / 55.011 | 110 | 80 | 16.00 / 15.957 | 10.0 / 9.91 | 49.0 / 48.8 | M20X40 | 455 | 470 | 865 | 400.5 / 399.5 | 350.018 / 349.982 | 450 | 19 | 5 | 19 | 305 | 618 |
| ND250S | 60.030 / 60.011 | 140 | 110 | 18.00 / 17.957 | 11.00 / 10.91 | 53.0 / 52.8 | M20X40 | 485 | 500 | 1020 | 500.5 / 499.5 | 450.020 / 449.980 | 550 | 19 | 5 | 22 | 343 | 688 |
| ND250MX | 60.030 / 60.011 | 140 | 110 | 18.00 / 17.957 | 11.00 / 10.91 | 53.0 / 52.8 | M20X40 | 485 | 500 | 1050 | 500.5 / 499.5 | 450.020 / 449.980 | 550 | 19 | 5 | 22 | 343 | 688 |
| ND280S | 65.030 / 65.011 | 140 | 110 | 18.00 / 17.957 | 11.00 / 10.91 | 58.0 / 57.8 | M20X40 | 530 | 536 | 1170 | 500.5 / 499.5 | 450.020 / 449.980 | 550 | 19 | 5 | 22 | 400 | 722 |
| ND280M | 65.030 / 65.011 | 140 | 110 | 18.00 / 17.957 | 11.00 / 10.91 | 58.0 / 57.8 | M20X40 | 530 | 536 | 1170 | 500.5 / 499.5 | 450.020 / 449.980 | 550 | 19 | 5 | 22 | 400 | 722 |
| ND315S | 65.030 / 65.011 | 140 | 110 | 18.00 / 17.957 | 11.00 / 10.91 | 58.0 / 57.8 | M20X40 | 530 | 590 | 1295 | 601.0 / 599.0 | 550.022 / 549.978 | 660 | 24 | 6 | 25 | 445 | 812 |
| ND315M | 65.030 / 65.011 | 140 | 110 | 18.00 / 17.957 | 11.00 / 10.91 | 58.0 / 57.8 | M20X40 | 530 | 590 | 1295 | 601.0 / 599.0 | 550.022 / 549.978 | 660 | 24 | 6 | 25 | 445 | 812 |
| ND315L | 70.030 / 70.011 | 140 | 110 | 20.00 / 19.948 | 12.00 / 11.91 | 62.5 / 62.3 | M20X40 | 570 | 655 | 1460 | 601.0 / 599.0 | 550.022 / 549.948 | 660 | 24 | 6 | 25 | 530 | 880 |
| ND315LX | 70.030 / 70.011 | 140 | 110 | 20.00 / 19.948 | 12.00 / 11.91 | 62.5 / 62.3 | M20X40 | 570 | 655 | 1460 | 601.0 / 599.0 | 550.022 / 549.948 | 660 | 24 | 6 | 25 | 530 | 880 |
| ND355S | 75.030 / 75.011 | 170 | 140 | 20.00 / 19.948 | 12.00 / 11.91 | 67.5 / 67.3 | M20X40 | 720 | 720 | 1610 | 741.0 / 739.0 | 680.025 / 679.975 | 800 | 24 | 6 | 28 | 570 | 900 |
| ND355M | 75.030 / 75.011 | 170 | 140 | 20.00 / 19.948 | 12.00 / 11.91 | 67.5 / 67.3 | M20X40 | 720 | 720 | 1610 | 741.0 / 739.0 | 680.025 / 679.975 | 800 | 24 | 6 | 28 | 570 | 900 |
| ND355L | 75.030 / 75.011 | 170 | 140 | 20.00 / 19.948 | 12.00 / 11.91 | 67.5 / 67.3 | M20X40 | 720 | 720 | 1610 | 741.0 / 739.0 | 680.025 / 679.975 | 800 | 24 | 6 | 28 | 570 | 900 |

* Some features may be different and may not be a part of standard product.

TEFC, 3 PHASE FLANGE MOUNTED CAST IRON INDUCTION MOTORS (FRAME ND355LX)

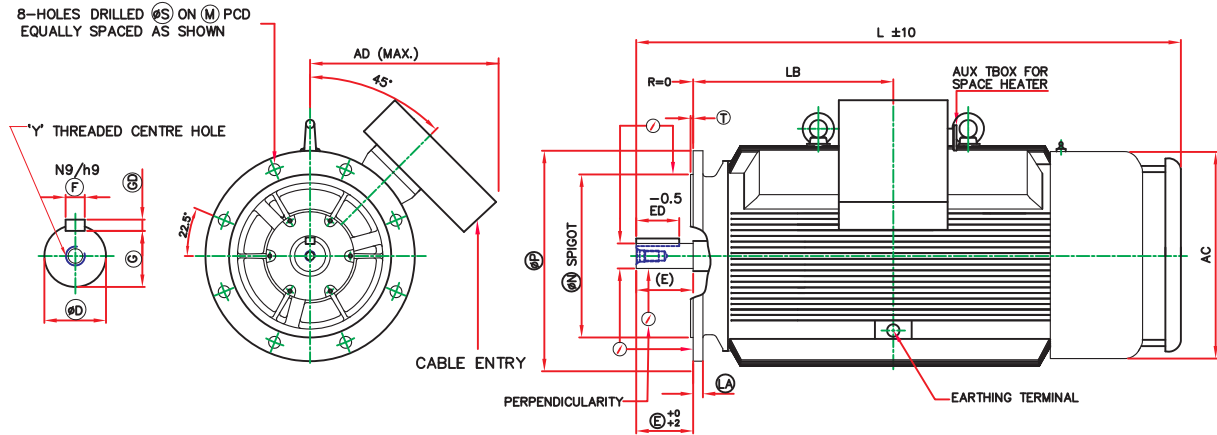

RINGED DIMENSIONS ARE AS PER IEC:60072-1
ALL DIMENSIONS ARE IN mm

| Frame | D | E | ED | F | GD | G | Y | AD | AC | L | MTol | NTol | P | S | T | LA | LB | HB |
|-----------|---------------------|-----|-----|------------------|-----------------|---------------|--------|-----|-----|------|-----------------|---------------------|-----|----|---|----|-----|-----|
| POLE :2 | | | | | | | | | | | | | | | | | | |
| ND355LX | 75.030/ 75.011 | 170 | 140 | 20.00/ 19.948 | 12.00/ 11.91 | 67.5/ 67.3 | M20X40 | 720 | 720 | 1540 | 741.0/ 739.0 | 680.025/ 679.975 | 800 | 24 | 6 | 28 | 570 | 900 |
| POLE :4,6 | | | | | | | | | | | | | | | | | | |
| ND355LX | 100.035/ 100.013 | 210 | 160 | 28.00/ 27.948 | 16.00/ 15.89 | 90.0/ 89.8 | M24X50 | 720 | 720 | 1580 | 741.0/ 739.0 | 680.025/ 679.975 | 800 | 24 | 6 | 28 | 570 | 900 |

* Some features may be different and may not be a part of standard product.

PERFORMANCE DATA FOR ALUMINIUM MOTORS

Efficiency values complying to Eff-2 class of IEC 60034-2004

| RATED POWER | | FRAME | FULL LOAD CURRENT | | | FL SPEED RPM | FLT kg.m | EFFICIENCY | | | POWER FACTOR | | | D.O.L STARTING | | PULLOUT POT %FLT | GD ² kg.m ² |
|--|-------|--------|-------------------|------|------|--------------------|-------------|------------|------|------|--------------|------|------|----------------|-------------|------------------------|--------------------------------------|
| kW | hp | | 380V | 400V | 415V | | | FL | 3/4L | 1/2L | FL | 3/4L | 1/2L | STT %FLT | SSC %FLA | | |
| 2 POLE - 3000 Synchronous rpm, 50Hz | | | | | | | | | | | | | | | | | |
| 0.18 | 0.25 | GD63 | 0.62 | 0.59 | 0.57 | 2810 | 0.06 | 64.0 | 61.0 | 56.0 | 0.69 | 0.60 | 0.49 | 190 | 550 | 240 | 0.0010 |
| 0.25 | 0.33 | GD63 | 0.73 | 0.69 | 0.67 | 2810 | 0.09 | 66.0 | 64.0 | 60.0 | 0.79 | 0.72 | 0.61 | 230 | 450 | 250 | 0.0016 |
| 0.37 | 0.50 | GD71S | 0.93 | 0.88 | 0.85 | 2815 | 0.13 | 72.0 | 73.0 | 72.0 | 0.84 | 0.78 | 0.66 | 180 | 500 | 210 | 0.0013 |
| 0.55 | 0.75 | GD71S | 1.30 | 1.23 | 1.19 | 2820 | 0.19 | 74.0 | 75.0 | 73.0 | 0.87 | 0.83 | 0.73 | 190 | 500 | 210 | 0.0018 |
| 0.75 | 1.00 | GD80M | 1.78 | 1.69 | 1.63 | 2850 | 0.26 | 77.0 | 77.0 | 73.0 | 0.83 | 0.79 | 0.68 | 220 | 550 | 250 | 0.0034 |
| 1.1 | 1.50 | GD80M | 2.52 | 2.39 | 2.30 | 2870 | 0.37 | 81.0 | 81.0 | 79.0 | 0.82 | 0.77 | 0.66 | 270 | 670 | 270 | 0.0047 |
| 1.5 | 2.00 | GD90S | 3.39 | 3.22 | 3.10 | 2870 | 0.51 | 82.0 | 82.0 | 80.0 | 0.82 | 0.77 | 0.66 | 250 | 600 | 300 | 0.0047 |
| 2.2 | 3.00 | GD90L | 4.63 | 4.40 | 4.24 | 2850 | 0.75 | 84.0 | 84.0 | 82.0 | 0.86 | 0.83 | 0.73 | 250 | 630 | 300 | 0.0067 |
| 3.0 | 4.00 | GD100L | 6.0 | 5.7 | 5.5 | 2875 | 1.02 | 86.0 | 86.0 | 84.0 | 0.88 | 0.83 | 0.75 | 300 | 700 | 310 | 0.0192 |
| 3.7 | 5.00 | GD100L | 7.4 | 7.0 | 6.7 | 2875 | 1.25 | 86.5 | 87.5 | 86.5 | 0.88 | 0.83 | 0.75 | 300 | 700 | 310 | 0.0192 |
| 4.0 | 5.50 | GD112M | 8.0 | 7.6 | 7.3 | 2870 | 1.36 | 86.5 | 86.5 | 86.0 | 0.88 | 0.83 | 0.75 | 275 | 780 | 310 | 0.0240 |
| 5.5 | 7.50 | GD132S | 10.8 | 10.3 | 9.8 | 2910 | 1.84 | 86.0 | 86.0 | 84.0 | 0.90 | 0.85 | 0.73 | 270 | 820 | 300 | 0.0579 |
| 7.5 | 10.00 | GD132S | 15.0 | 14.3 | 13.7 | 2900 | 2.52 | 87.0 | 89.0 | 88.0 | 0.87 | 0.87 | 0.82 | 250 | 820 | 300 | 0.0752 |
| 4 POLE - 1500 Synchronous rpm, 50Hz | | | | | | | | | | | | | | | | | |
| 0.18 | 0.25 | GD63 | 0.67 | 0.63 | 0.61 | 1370 | 0.13 | 64.0 | 63.0 | 58.0 | 0.64 | 0.58 | 0.47 | 220 | 500 | 250 | 0.002 |
| 0.25 | 0.33 | GD71 | 0.85 | 0.80 | 0.77 | 1400 | 0.17 | 68.0 | 68.0 | 63.0 | 0.66 | 0.59 | 0.49 | 180 | 400 | 220 | 0.003 |
| 0.37 | 0.50 | GD71S | 1.16 | 1.11 | 1.07 | 1410 | 0.26 | 71.0 | 69.5 | 64.5 | 0.68 | 0.61 | 0.50 | 180 | 400 | 220 | 0.003 |
| 0.55 | 0.75 | GD80M | 1.66 | 1.58 | 1.52 | 1400 | 0.38 | 75.0 | 75.0 | 73.0 | 0.67 | 0.61 | 0.51 | 200 | 420 | 250 | 0.006 |
| 0.75 | 1.00 | GD80M | 1.97 | 1.88 | 1.81 | 1410 | 0.52 | 78.0 | 78.0 | 76.0 | 0.74 | 0.68 | 0.54 | 200 | 440 | 250 | 0.007 |
| 1.1 | 1.50 | GD90S | 2.78 | 2.64 | 2.55 | 1410 | 0.76 | 79.0 | 79.0 | 77.0 | 0.76 | 0.69 | 0.56 | 220 | 510 | 250 | 0.010 |
| 1.5 | 2.00 | GD90L | 3.70 | 3.52 | 3.39 | 1420 | 1.03 | 81.0 | 82.0 | 81.0 | 0.76 | 0.71 | 0.59 | 250 | 560 | 280 | 0.014 |
| 2.2 | 3.00 | GD100L | 5.0 | 4.7 | 4.6 | 1415 | 1.51 | 83.0 | 82.0 | 81.0 | 0.80 | 0.76 | 0.64 | 200 | 550 | 250 | 0.023 |
| 3.0 | 4.00 | GD100L | 6.9 | 6.5 | 6.3 | 1435 | 2.04 | 84.0 | 84.0 | 82.0 | 0.79 | 0.75 | 0.68 | 200 | 600 | 250 | 0.054 |
| 3.7 | 5.00 | GD112M | 8.4 | 7.9 | 7.6 | 1435 | 2.51 | 85.0 | 85.0 | 84.0 | 0.79 | 0.75 | 0.68 | 200 | 550 | 250 | 0.054 |
| 4.0 | 5.50 | GD112M | 9.2 | 8.7 | 8.4 | 1435 | 2.71 | 85.0 | 85.0 | 84.0 | 0.78 | 0.72 | 0.62 | 200 | 550 | 250 | 0.054 |
| 5.5 | 7.50 | GD132S | 12.0 | 11.4 | 11.0 | 1445 | 3.71 | 85.7 | 86.0 | 85.0 | 0.81 | 0.74 | 0.62 | 225 | 700 | 300 | 0.098 |
| 7.5 | 10.00 | GD132M | 15.9 | 15.1 | 14.6 | 1445 | 5.06 | 87.0 | 87.0 | 86.0 | 0.82 | 0.78 | 0.68 | 240 | 720 | 300 | 0.131 |

* Tolerances are applicable as per IEC 60034-2004

Full load current indicated are given for respective voltage designs

PERFORMANCE DATA FOR ALUMINIUM MOTORS

Efficiency values complying to Eff-2 class of IEC 60034-2004

| RATED POWER | | FRAME | FULL LOAD CURRENT | | | FL SPEED RPM | FLT kg.m | EFFICIENCY | | | POWER FACTOR | | | D.O.L STARTING | | PULLOUT POT %FLT | GD ² kg.m ² |
|--|------|--------|-------------------|------|------|--------------------|-------------|------------|------|------|--------------|------|------|----------------|-------------|------------------------|--------------------------------------|
| kW | hp | | 380V | 400V | 415V | | | FL | 3/4L | 1/2L | FL | 3/4L | 1/2L | S T T %FLT | SSC %FLA | | |
| 6 POLE - 1000 Synchronous rpm, 50Hz | | | | | | | | | | | | | | | | | |
| 0.18 | 0.25 | GD71 | 0.79 | 0.75 | 0.72 | 910 | 0.19 | 61.0 | 61.0 | 58.0 | 0.57 | 0.52 | 0.40 | 170 | 400 | 190 | 0.003 |
| 0.25 | 0.33 | GD71 | 1.11 | 1.06 | 1.02 | 920 | 0.26 | 61.0 | 61.0 | 58.0 | 0.56 | 0.53 | 0.43 | 170 | 300 | 190 | 0.005 |
| 0.37 | 0.50 | GD80M | 1.18 | 1.12 | 1.08 | 920 | 0.39 | 70.0 | 70.0 | 68.0 | 0.68 | 0.6 | 0.48 | 200 | 300 | 250 | 0.007 |
| 0.55 | 0.75 | GD80M | 1.87 | 1.77 | 1.71 | 920 | 0.58 | 71.0 | 71.0 | 66.0 | 0.63 | 0.58 | 0.46 | 200 | 370 | 230 | 0.010 |
| 0.75 | 1.00 | GD90S | 2.23 | 2.12 | 2.04 | 920 | 0.79 | 74.0 | 74.0 | 72.0 | 0.69 | 0.62 | 0.50 | 220 | 450 | 250 | 0.012 |
| 1.1 | 1.5 | GD90L | 3.40 | 3.23 | 3.11 | 940 | 1.14 | 78.0 | 77.0 | 75.0 | 0.63 | 0.56 | 0.46 | 250 | 450 | 300 | 0.019 |
| 1.5 | 2.00 | GD100L | 4.5 | 4.3 | 4.1 | 930 | 1.57 | 79.0 | 79.0 | 77.0 | 0.64 | 0.58 | 0.47 | 200 | 420 | 250 | 0.030 |
| 2.2 | 3.00 | GD112M | 5.8 | 5.5 | 5.3 | 950 | 2.26 | 82.0 | 82.0 | 80.0 | 0.70 | 0.63 | 0.51 | 280 | 580 | 300 | 0.058 |
| 3.0 | 4.00 | GD132S | 7.5 | 6.9 | 6.7 | 960 | 3.04 | 82.0 | 81.5 | 79.0 | 0.76 | 0.70 | 0.59 | 250 | 600 | 275 | 0.152 |
| 3.7 | 5.00 | GD132S | 8.9 | 8.5 | 8.2 | 960 | 3.75 | 82.5 | 82.0 | 80.0 | 0.76 | 0.70 | 0.59 | 250 | 500 | 275 | 0.152 |
| 4.0 | 5.5 | GD132M | 9.8 | 9.3 | 8.9 | 960 | 4.06 | 83.0 | 82.0 | 80.0 | 0.75 | 0.67 | 0.55 | 210 | 620 | 260 | 0.160 |
| 5.5 | 7.50 | GD132M | 13.5 | 12.8 | 12.4 | 960 | 5.58 | 84.5 | 83.5 | 81.0 | 0.73 | 0.67 | 0.55 | 210 | 471 | 260 | 0.174 |
| 8 POLE - 750 Synchronous rpm, 50Hz | | | | | | | | | | | | | | | | | |
| 0.18 | 0.25 | GD80M | 1.08 | 1.03 | 0.99 | 695 | 0.25 | 55.0 | 52.0 | 44.0 | 0.46 | 0.39 | 0.30 | 170 | 270 | 190 | 0.005 |
| 0.25 | 0.33 | GD80M | 1.52 | 1.45 | 1.4 | 640 | 0.38 | 47.0 | 45.0 | 40.0 | 0.53 | 0.46 | 0.36 | 175 | 250 | 225 | 0.006 |
| 0.37 | 0.50 | GD90S | 1.71 | 1.63 | 1.57 | 700 | 0.51 | 62.0 | 59.0 | 51.0 | 0.53 | 0.44 | 0.34 | 180 | 320 | 200 | 0.012 |
| 0.55 | 0.75 | GD90L | 2.57 | 2.44 | 2.36 | 680 | 0.79 | 58.0 | 58.0 | 51.0 | 0.56 | 0.44 | 0.33 | 180 | 320 | 200 | 0.016 |
| 0.75 | 1.00 | GD100L | 3.0 | 2.8 | 2.7 | 690 | 1.06 | 70.0 | 68.0 | 61.0 | 0.54 | 0.49 | 0.40 | 170 | 330 | 200 | 0.030 |
| 1.1 | 1.50 | GD100L | 4.1 | 3.9 | 3.8 | 690 | 1.55 | 73.0 | 70.5 | 68.0 | 0.55 | 0.5 | 0.39 | 170 | 330 | 200 | 0.033 |
| 1.5 | 2.00 | GD112M | 4.6 | 4.3 | 4.2 | 690 | 2.12 | 74.0 | 73.0 | 71.0 | 0.67 | 0.56 | 0.44 | 170 | 400 | 190 | 0.058 |
| 2.2 | 3.00 | GD132S | 6.3 | 6.0 | 5.8 | 720 | 2.98 | 82.5 | 80.0 | 77.0 | 0.64 | 0.58 | 0.48 | 160 | 400 | 200 | 0.163 |
| 3.0 | 4.00 | GD132M | 8.8 | 8.4 | 8.1 | 720 | 4.06 | 81.0 | 80.0 | 77.0 | 0.64 | 0.58 | 0.48 | 175 | 400 | 200 | 0.165 |

* Tolerances are applicable as per IEC 60034-2004

Full load current indicated are given for respective voltage designs

PERFORMANCE DATA FOR CAST IRON MOTORS

Efficiency values complying to Eff-2 class of IEC 60034-2004

| RATED POWER | | FRAME | FULL LOAD CURRENT | | | FL SPEED RPM | FLT kg.m | EFFICIENCY | | | POWER FACTOR | | | D.O.L STARTING | | PULLOUT POT %FLT | GD ² kg.m ² |
|--|--------|---------|-------------------|------|------|--------------------|-------------|------------|------|------|--------------|------|------|----------------|------|------------------------|--------------------------------------|
| kW | hp | | 380V | 400V | 415V | | | FL | 3/4L | 1/2L | FL | 3/4L | 1/2L | %FLT | %FLA | | |
| 2 Pole - 3000 Synchronous rpm, 50Hz | | | | | | | | | | | | | | | | | |
| 0.55 | 0.75 | ND80 | 1.39 | 1.32 | 1.28 | 2820 | 0.19 | 75.0 | 73.0 | 68.0 | 0.80 | 0.73 | 0.68 | 225 | 600 | 275 | 0.0035 |
| 0.75 | 1.00 | ND80 | 1.88 | 1.78 | 1.72 | 2820 | 0.26 | 75.0 | 73.0 | 68.0 | 0.81 | 0.73 | 0.60 | 250 | 600 | 300 | 0.0035 |
| 1.10 | 1.50 | ND80 | 2.65 | 2.51 | 2.42 | 2820 | 0.38 | 78.0 | 76.0 | 71.0 | 0.81 | 0.75 | 0.65 | 225 | 600 | 300 | 0.0043 |
| 1.50 | 2.00 | ND90S | 3.47 | 3.30 | 3.18 | 2830 | 0.52 | 80.0 | 79.0 | 77.0 | 0.82 | 0.77 | 0.70 | 250 | 600 | 300 | 0.0060 |
| 2.20 | 3.00 | ND90L | 5.03 | 4.78 | 4.61 | 2830 | 0.76 | 81.0 | 80.0 | 77.0 | 0.82 | 0.76 | 0.68 | 250 | 600 | 300 | 0.0080 |
| 3.00 | 4.00 | ND100L | 6.5 | 6.1 | 5.1 | 2865 | 1.02 | 83.0 | 83.0 | 80.0 | 0.85 | 0.81 | 0.73 | 250 | 700 | 300 | 0.0150 |
| 3.70 | 5.00 | ND100L | 7.9 | 7.5 | 7.3 | 2840 | 1.27 | 84.5 | 83.5 | 82.0 | 0.84 | 0.80 | 0.74 | 250 | 600 | 300 | 0.0190 |
| 4.00 | 5.50 | ND112M | 8.3 | 7.9 | 7.6 | 2880 | 1.35 | 84.5 | 84.3 | 82.0 | 0.87 | 0.85 | 0.80 | 250 | 650 | 300 | 0.0400 |
| 5.50 | 7.50 | ND132S | 11.2 | 10.6 | 10.2 | 2865 | 1.87 | 86.0 | 85.0 | 84.0 | 0.87 | 0.82 | 0.78 | 225 | 600 | 300 | 0.0528 |
| 7.50 | 10.00 | ND132S | 14.8 | 14.1 | 13.6 | 2880 | 2.54 | 87.5 | 87.0 | 86.0 | 0.88 | 0.85 | 0.80 | 250 | 650 | 300 | 0.0530 |
| 9.30 | 12.50 | ND160M | 18 | 17 | 17 | 2920 | 3.10 | 88.0 | 87.0 | 85.0 | 0.88 | 0.86 | 0.78 | 250 | 600 | 300 | 0.1300 |
| 11.00 | 15.00 | ND160M | 21 | 20 | 20 | 2920 | 3.67 | 88.5 | 88.0 | 86.0 | 0.88 | 0.86 | 0.78 | 250 | 600 | 300 | 0.1300 |
| 15.00 | 20.00 | ND160M | 29 | 27 | 26 | 2920 | 5.00 | 89.5 | 89.5 | 87.5 | 0.88 | 0.86 | 0.79 | 250 | 650 | 300 | 0.1700 |
| 18.50 | 25.00 | ND160L | 35 | 34 | 32 | 2920 | 6.17 | 90.0 | 90.0 | 88.0 | 0.88 | 0.86 | 0.79 | 250 | 650 | 300 | 0.2100 |
| 22.00 | 30.00 | ND180M | 44 | 42 | 40 | 2940 | 7.29 | 91.0 | 91.0 | 89.0 | 0.84 | 0.80 | 0.74 | 200 | 500 | 250 | 0.4400 |
| 30.00 | 40.00 | ND200L | 57 | 54 | 52 | 2950 | 9.91 | 91.5 | 91.0 | 89.0 | 0.87 | 0.84 | 0.80 | 200 | 600 | 250 | 0.8000 |
| 37.00 | 50.00 | ND200L | 70 | 66 | 64 | 2960 | 12.18 | 92.5 | 92.0 | 90.0 | 0.87 | 0.84 | 0.80 | 200 | 500 | 250 | 0.8030 |
| 45.00 | 60.00 | ND225M | 79 | 75 | 72 | 2955 | 14.83 | 92.0 | 92.0 | 90.0 | 0.94 | 0.92 | 0.88 | 225 | 650 | 275 | 1.8700 |
| 55.00 | 75.00 | ND250M | 96 | 91 | 88 | 2955 | 18.13 | 93.0 | 92.5 | 90.5 | 0.94 | 0.92 | 0.88 | 200 | 600 | 250 | 1.7900 |
| 75.00 | 100.00 | ND280S | 135 | 129 | 124 | 2970 | 24.60 | 93.6 | 93.5 | 92.0 | 0.90 | 0.86 | 0.78 | 200 | 600 | 250 | 2.7900 |
| 90.00 | 120.00 | ND280M | 162 | 154 | 148 | 2970 | 29.52 | 94.0 | 94.0 | 92.5 | 0.90 | 0.86 | 0.78 | 200 | 600 | 250 | 3.4000 |
| 110.00 | 150.00 | ND315S | 189 | 180 | 173 | 2965 | 36.13 | 94.0 | 94.0 | 92.5 | 0.94 | 0.91 | 0.86 | 150 | 600 | 225 | 5.8229 |
| 132.00 | 180.00 | ND315M | 226 | 214 | 207 | 2965 | 43.36 | 94.5 | 94.5 | 92.5 | 0.94 | 0.91 | 0.86 | 160 | 600 | 225 | 6.6548 |
| 160.00 | 215.00 | ND315L | 273 | 259 | 250 | 2975 | 52.38 | 94.8 | 94.3 | 92.5 | 0.94 | 0.90 | 0.88 | 200 | 600 | 250 | 12.4106 |
| 180.00 | 240.00 | ND315L | 306 | 291 | 280 | 2975 | 58.93 | 95.0 | 94.5 | 92.5 | 0.94 | 0.92 | 0.88 | 225 | 650 | 275 | 13.8495 |
| 200.00 | 270.00 | ND315LX | 339 | 322 | 310 | 2970 | 65.59 | 95.3 | 94.5 | 93.0 | 0.94 | 0.92 | 0.88 | 175 | 600 | 225 | 16.3676 |
| 225.00 | 300.00 | ND355L | 381 | 362 | 349 | 2970 | 73.79 | 95.5 | 94.8 | 93.4 | 0.91 | 0.89 | 0.85 | 225 | 600 | 275 | 18.3462 |
| 250.00 | 335.00 | ND355LX | 423 | 402 | 387 | 2975 | 81.99 | 95.5 | 94.8 | 93.3 | 0.94 | 0.92 | 0.88 | 150 | 650 | 225 | 27.6700 |
| 275.00 | 370.00 | ND355LX | 476 | 452 | 435 | 2980 | 89.88 | 95.5 | 94.8 | 93.3 | 0.92 | 0.90 | 0.86 | 150 | 600 | 225 | 27.7738 |
| 315.00 | 425.00 | ND355LX | 545 | 518 | 499 | 2980 | 102.96 | 95.5 | 94.8 | 92.5 | 0.92 | 0.90 | 0.86 | 175 | 600 | 225 | 29.4517 |

* Tolerances are applicable as per IEC 60034-2004

Full load current indicated are given for respective voltage designs

PERFORMANCE DATA FOR CAST IRON MOTORS

Efficiency values complying to Eff-2 class of IEC 60034-2004

| RATED POWER | | FRAME | FULL LOAD CURRENT | | | FL SPEED RPM | FLT kg.m | EFFICIENCY | | | POWER FACTOR | | | D.O.L STARTING | | PULLOUT POT %FLT | GD ² kg.m ² |
|--|--------|---------|-------------------|------|------|--------------------|-------------|------------|------|------|--------------|------|------|----------------|-------------|------------------------|--------------------------------------|
| kW | hp | | 380V | 400V | 415V | | | FL | 3/4L | 1/2L | FL | 3/4L | 1/2L | STT %FLT | SSC %FLA | | |
| 4 Pole - 1500 Synchronous rpm, 50Hz | | | | | | | | | | | | | | | | | |
| 0.55 | 0.75 | ND80 | 1.57 | 1.49 | 1.44 | 1410 | 0.38 | 73.0 | 72.0 | 69.0 | 0.73 | 0.67 | 0.54 | 200 | 500 | 275 | 0.010 |
| 0.75 | 1.00 | ND80 | 1.97 | 1.87 | 1.81 | 1410 | 0.52 | 77.0 | 74.0 | 69.0 | 0.75 | 0.68 | 0.58 | 200 | 500 | 275 | 0.010 |
| 1.10 | 1.50 | ND90S | 2.78 | 2.64 | 2.55 | 1415 | 0.76 | 78.0 | 76.0 | 74.0 | 0.77 | 0.72 | 0.64 | 200 | 500 | 275 | 0.014 |
| 1.50 | 2.00 | ND90L | 3.61 | 3.43 | 3.30 | 1415 | 1.03 | 80.0 | 79.0 | 77.0 | 0.79 | 0.75 | 0.68 | 200 | 550 | 275 | 0.020 |
| 2.20 | 3.00 | ND100L | 5.03 | 4.8 | 4.6 | 1430 | 1.50 | 82.0 | 81.0 | 78.0 | 0.81 | 0.76 | 0.66 | 200 | 600 | 275 | 0.030 |
| 3.00 | 4.00 | ND100L | 6.7 | 6.4 | 6.2 | 1425 | 2.05 | 82.6 | 81.0 | 78.0 | 0.82 | 0.76 | 0.68 | 200 | 600 | 275 | 0.040 |
| 3.70 | 5.00 | ND112M | 8.1 | 7.7 | 7.4 | 1430 | 2.52 | 85.0 | 85.0 | 83.0 | 0.82 | 0.77 | 0.68 | 200 | 600 | 275 | 0.050 |
| 4.00 | 5.50 | ND112M | 8.9 | 8.5 | 8.2 | 1430 | 2.72 | 84.2 | 83.0 | 78.0 | 0.81 | 0.76 | 0.69 | 200 | 600 | 275 | 0.045 |
| 5.50 | 7.50 | ND132S | 11.3 | 10.7 | 10.3 | 1450 | 3.69 | 86.0 | 85.0 | 83.0 | 0.86 | 0.82 | 0.75 | 225 | 600 | 275 | 0.130 |
| 7.50 | 10.00 | ND132M | 15.1 | 14.3 | 13.8 | 1455 | 5.02 | 87.0 | 86.0 | 84.0 | 0.87 | 0.84 | 0.76 | 225 | 600 | 275 | 0.160 |
| 9.30 | 12.50 | ND160M | 19 | 18 | 17 | 1460 | 6.20 | 88.5 | 88.5 | 86.5 | 0.84 | 0.81 | 0.73 | 175 | 500 | 225 | 0.310 |
| 11.00 | 15.00 | ND160M | 23 | 22 | 21 | 1460 | 7.34 | 89.0 | 89.0 | 86.0 | 0.82 | 0.79 | 0.70 | 200 | 500 | 250 | 0.360 |
| 15.00 | 20.00 | ND160L | 30 | 28 | 27 | 1460 | 10.01 | 90.0 | 90.0 | 88.0 | 0.85 | 0.83 | 0.75 | 200 | 500 | 250 | 0.470 |
| 18.50 | 25.00 | ND180M | 37 | 35 | 33 | 1475 | 12.22 | 91.5 | 91.5 | 90.0 | 0.84 | 0.80 | 0.72 | 200 | 500 | 250 | 0.710 |
| 22.00 | 30.00 | ND180L | 43 | 41 | 40 | 1475 | 14.53 | 92.0 | 92.0 | 90.0 | 0.84 | 0.80 | 0.72 | 200 | 500 | 250 | 0.950 |
| 30.00 | 40.00 | ND200L | 58 | 55 | 53 | 1475 | 19.81 | 92.0 | 92.0 | 90.5 | 0.86 | 0.82 | 0.76 | 225 | 600 | 275 | 1.620 |
| 37.00 | 50.00 | ND225S | 68 | 65 | 63 | 1480 | 24.35 | 92.5 | 92.5 | 91.6 | 0.89 | 0.86 | 0.78 | 250 | 600 | 300 | 2.640 |
| 45.00 | 60.00 | ND225M | 83 | 78 | 76 | 1480 | 29.61 | 93.0 | 93.0 | 91.5 | 0.89 | 0.86 | 0.78 | 250 | 600 | 300 | 3.130 |
| 55.00 | 75.00 | ND250M | 100 | 95 | 92 | 1475 | 36.32 | 93.5 | 93.5 | 92.0 | 0.89 | 0.86 | 0.82 | 200 | 600 | 250 | 3.450 |
| 75.00 | 100.00 | ND280S | 135 | 128 | 123 | 1480 | 49.36 | 94.0 | 94.0 | 92.5 | 0.90 | 0.88 | 0.82 | 200 | 600 | 250 | 6.282 |
| 90.00 | 120.00 | ND280M | 161 | 153 | 147 | 1480 | 59.23 | 94.5 | 94.5 | 92.5 | 0.90 | 0.88 | 0.82 | 225 | 600 | 275 | 7.220 |
| 110.00 | 150.00 | ND315S | 192 | 183 | 176 | 1485 | 72.15 | 94.5 | 94.5 | 92.0 | 0.92 | 0.88 | 0.86 | 225 | 600 | 275 | 11.62 |
| 132.00 | 180.00 | ND315M | 245 | 233 | 225 | 1490 | 86.29 | 95.0 | 95.0 | 93.5 | 0.86 | 0.82 | 0.74 | 175 | 600 | 225 | 13.44 |
| 150.00 | 200.00 | ND315M | 279 | 265 | 255 | 1489 | 98.12 | 95.0 | 94.0 | 92.5 | 0.86 | 0.82 | 0.74 | 160 | 600 | 225 | 14.00 |
| 160.00 | 215.00 | ND315L | 283 | 269 | 260 | 1488 | 104.73 | 95.3 | 95.3 | 94.0 | 0.90 | 0.88 | 0.80 | 175 | 600 | 225 | 19.00 |
| 180.00 | 240.00 | ND315L | 319 | 303 | 292 | 1488 | 117.82 | 95.3 | 94.8 | 93.8 | 0.90 | 0.88 | 0.84 | 175 | 600 | 225 | 21.14 |
| 200.00 | 270.00 | ND315LX | 354 | 336 | 324 | 1488 | 130.91 | 95.5 | 95.2 | 94.0 | 0.90 | 0.88 | 0.84 | 175 | 600 | 225 | 25.00 |
| 225.00 | 300.00 | ND355L | 393 | 374 | 360 | 1489 | 147.18 | 95.5 | 94.8 | 93.4 | 0.91 | 0.89 | 0.85 | 175 | 600 | 225 | 28.00 |
| 250.00 | 335.00 | ND355LX | 432 | 411 | 396 | 1488 | 163.64 | 95.5 | 95.2 | 93.8 | 0.92 | 0.88 | 0.84 | 150 | 600 | 225 | 29.60 |
| 275.00 | 370.00 | ND355LX | 481 | 457 | 440 | 1490 | 179.77 | 95.5 | 95.0 | 93.3 | 0.91 | 0.88 | 0.81 | 140 | 650 | 225 | 31.56 |
| 315.00 | 425.00 | ND355LX | 549 | 522 | 503 | 1490 | 205.91 | 95.8 | 95.1 | 93.6 | 0.91 | 0.88 | 0.82 | 140 | 650 | 225 | 35.46 |

* Tolerances are applicable as per IEC 60034-2004

Full load current indicated are given for respective voltage designs

PERFORMANCE DATA FOR CAST IRON MOTORS

Efficiency values complying to Eff-2 class of IEC 60034-2004

| RATED POWER | | FRAME | FULL LOAD CURRENT | | | FL SPEED RPM | FLT kg.m | EFFICIENCY | | | POWER FACTOR | | | D.O.L STARTING | | PULLOUT POT %FLT | GD ² kg.m ² |
|-------------|--------|---------|-------------------|------|------|--------------------|-------------|------------|------|------|--------------|------|------|----------------|-------------|------------------------|--------------------------------------|
| kW | hp | | 380V | 400V | 415V | | | FL | 3/4L | 1/2L | FL | 3/4L | 1/2L | S T T %FLT | SSC %FLA | | |
| 0.37 | 0.50 | ND80 | 1.24 | 1.2 | 1.13 | 910 | 0.40 | 65.0 | 63.0 | 59.0 | 0.70 | 0.63 | 0.50 | 200 | 400 | 250 | 0.011 |
| 0.55 | 0.75 | ND80 | 1.71 | 1.6 | 1.56 | 910 | 0.59 | 69.0 | 66.0 | 60.0 | 0.71 | 0.63 | 0.50 | 200 | 400 | 250 | 0.011 |
| 0.75 | 1.00 | ND90S | 2.17 | 2.1 | 1.99 | 935 | 0.78 | 73.0 | 71.0 | 65.0 | 0.72 | 0.65 | 0.55 | 200 | 500 | 250 | 0.015 |
| 1.10 | 1.50 | ND90L | 3.05 | 2.9 | 2.80 | 935 | 1.15 | 76.0 | 73.0 | 67.0 | 0.72 | 0.66 | 0.54 | 200 | 500 | 250 | 0.021 |
| 1.50 | 2.00 | ND100L | 4.1 | 3.9 | 3.7 | 935 | 1.56 | 78.0 | 76.0 | 73.0 | 0.72 | 0.66 | 0.56 | 200 | 500 | 250 | 0.030 |
| 2.20 | 3.00 | ND112M | 5.6 | 5.3 | 5.1 | 935 | 2.29 | 80.0 | 79.0 | 75.0 | 0.75 | 0.68 | 0.58 | 200 | 500 | 250 | 0.048 |
| 3.00 | 4.00 | ND132S | 7.0 | 6.7 | 6.4 | 940 | 3.11 | 82.0 | 82.0 | 80.0 | 0.79 | 0.75 | 0.68 | 200 | 500 | 250 | 0.160 |
| 3.70 | 5.00 | ND132S | 8.6 | 8.2 | 7.9 | 940 | 3.83 | 82.5 | 82.0 | 80.0 | 0.79 | 0.73 | 0.64 | 200 | 550 | 250 | 0.174 |
| 4.00 | 5.50 | ND132M | 9.2 | 8.7 | 8.4 | 950 | 4.10 | 83.0 | 81.0 | 78.0 | 0.80 | 0.75 | 0.68 | 200 | 550 | 250 | 0.300 |
| 5.50 | 7.50 | ND132M | 12 | 12 | 11 | 950 | 5.64 | 84.0 | 83.0 | 81.0 | 0.80 | 0.75 | 0.68 | 200 | 550 | 250 | 0.460 |
| 7.50 | 10.00 | ND160M | 16 | 15 | 15 | 970 | 7.53 | 87.5 | 87.0 | 85.0 | 0.80 | 0.76 | 0.68 | 175 | 500 | 225 | 0.460 |
| 9.30 | 12.50 | ND160L | 20 | 19 | 18 | 970 | 9.34 | 87.5 | 87.0 | 84.0 | 0.80 | 0.76 | 0.68 | 200 | 550 | 250 | 0.590 |
| 11.00 | 15.00 | ND160L | 24 | 23 | 22 | 975 | 10.99 | 88.0 | 87.5 | 86.0 | 0.80 | 0.76 | 0.68 | 200 | 550 | 250 | 0.640 |
| 15.00 | 20.00 | ND180L | 32 | 30 | 29 | 975 | 14.98 | 90.0 | 90.0 | 88.0 | 0.79 | 0.73 | 0.66 | 250 | 600 | 300 | 1.160 |
| 18.50 | 25.00 | ND200L | 37 | 35 | 34 | 975 | 18.48 | 91.1 | 91.1 | 89.9 | 0.84 | 0.80 | 0.70 | 200 | 550 | 250 | 1.690 |
| 22.00 | 30.00 | ND200L | 43 | 41 | 40 | 975 | 21.98 | 91.5 | 91.5 | 90.1 | 0.84 | 0.80 | 0.70 | 200 | 500 | 250 | 2.040 |
| 30.00 | 40.00 | ND225M | 58 | 55 | 53 | 980 | 29.82 | 92.0 | 92.0 | 90.5 | 0.85 | 0.81 | 0.72 | 200 | 550 | 250 | 3.610 |
| 37.00 | 50.00 | ND250M | 72 | 68 | 66 | 980 | 36.77 | 93.0 | 93.0 | 92.0 | 0.84 | 0.80 | 0.72 | 225 | 600 | 275 | 4.820 |
| 45.00 | 60.00 | ND280S | 86 | 82 | 79 | 980 | 44.72 | 93.0 | 93.0 | 91.0 | 0.85 | 0.81 | 0.73 | 225 | 600 | 275 | 8.010 |
| 55.00 | 75.00 | ND280M | 104 | 99 | 95 | 980 | 54.66 | 93.5 | 93.5 | 92.0 | 0.86 | 0.82 | 0.74 | 200 | 650 | 250 | 9.890 |
| 75.00 | 100.00 | ND315S | 147 | 139 | 134 | 987 | 74.01 | 93.5 | 93.0 | 91.0 | 0.83 | 0.76 | 0.64 | 200 | 600 | 250 | 14.100 |
| 90.00 | 120.00 | ND315M | 171 | 162 | 156 | 987 | 88.81 | 94.2 | 94.2 | 92.5 | 0.85 | 0.80 | 0.70 | 200 | 600 | 250 | 17.000 |
| 110.00 | 150.00 | ND315M | 206 | 195 | 188 | 987 | 108.55 | 94.5 | 94.5 | 92.5 | 0.86 | 0.82 | 0.74 | 200 | 600 | 250 | 19.000 |
| 132.00 | 180.00 | ND315L | 247 | 234 | 226 | 990 | 129.84 | 94.5 | 94.5 | 93.0 | 0.86 | 0.82 | 0.74 | 200 | 550 | 250 | 25.300 |
| 160.00 | 215.00 | ND315LX | 298 | 283 | 272 | 990 | 157.37 | 95.0 | 94.5 | 93.0 | 0.86 | 0.82 | 0.74 | 200 | 600 | 250 | 29.900 |
| 180.00 | 240.00 | ND355L | 334 | 318 | 306 | 990 | 177.05 | 95.1 | 95.1 | 93.5 | 0.86 | 0.82 | 0.76 | 200 | 600 | 250 | 33.160 |
| 200.00 | 270.00 | ND355LX | 381 | 362 | 349 | 990 | 196.75 | 95.0 | 95.0 | 93.5 | 0.84 | 0.81 | 0.72 | 130 | 500 | 225 | 29.700 |
| 225.00 | 300.00 | ND355LX | 426 | 405 | 390 | 991 | 221.31 | 95.5 | 95.0 | 94.0 | 0.84 | 0.80 | 0.70 | 130 | 500 | 225 | 31.700 |
| 250.00 | 335.00 | ND355LX | 474 | 450 | 434 | 990 | 245.90 | 95.5 | 95.0 | 94.0 | 0.84 | 0.80 | 0.70 | 130 | 500 | 225 | 35.600 |
| 275.00 | 370.00 | ND355LX | 521 | 495 | 477 | 990 | 270.55 | 95.5 | 95.0 | 94.0 | 0.84 | 0.80 | 0.74 | 160 | 500 | 225 | 39.520 |
| 315.00 | 425.00 | ND355LX | 581 | 552 | 532 | 995 | 308.35 | 95.8 | 95.4 | 94.0 | 0.86 | 0.82 | 0.77 | 150 | 500 | 225 | 42.400 |

* Tolerances are applicable as per IEC 60034-2004

Full load current indicated are given for respective voltage designs

NOTE : As the design and manufacture of Crompton Greaves electrical equipment are subject to constant improvement ,the product supplied may differ in some details from the specifications and illustrations given in this booklet.

For more details ,contact CG Sales.

PERFORMANCE DATA FOR CAST IRON MOTORS

Efficiency values complying to Eff-2 class of IEC 60034-2004

| RATED POWER | | FRAME | FULL LOAD CURRENT | | | FL SPEED RPM | FLT kg.m | EFFICIENCY | | | POWER FACTOR | | | D.O.L STARTING | | PULLOUT POT %FLT | GD ² kg.m ² |
|--|--------|---------|-------------------|------|------|--------------------|-------------|------------|------|------|--------------|------|------|----------------|-------------|------------------------|--------------------------------------|
| kW | hp | | 380V | 400V | 415V | | | FL | 3/4L | 1/2L | FL | 3/4L | 1/2L | S T T %FLT | SSC %FLA | | |
| 8 Pole - 1000 Synchronous rpm, 50Hz | | | | | | | | | | | | | | | | | |
| 0.37 | 0.50 | ND90S | 1.54 | 1.46 | 1.41 | 680 | 0.53 | 64.0 | 60.0 | 54.0 | 0.57 | 0.50 | 0.40 | 170 | 400 | 225 | 0.016 |
| 0.55 | 0.75 | ND90L | 1.95 | 1.85 | 1.79 | 680 | 0.79 | 68.0 | 65.0 | 60.0 | 0.63 | 0.54 | 0.40 | 150 | 400 | 225 | 0.021 |
| 0.75 | 1.00 | ND100L | 2.9 | 2.7 | 2.6 | 700 | 1.04 | 70.0 | 67.0 | 62.0 | 0.57 | 0.51 | 0.42 | 175 | 400 | 225 | 0.029 |
| 1.10 | 1.50 | ND100L | 3.9 | 3.7 | 3.5 | 700 | 1.53 | 72.0 | 69.0 | 65.0 | 0.60 | 0.55 | 0.44 | 175 | 400 | 225 | 0.034 |
| 1.50 | 2.00 | ND112M | 4.4 | 4.2 | 4.0 | 700 | 2.09 | 76.0 | 74.0 | 71.0 | 0.68 | 0.60 | 0.48 | 190 | 400 | 225 | 0.056 |
| 2.20 | 3.00 | ND132S | 5.9 | 5.6 | 5.4 | 710 | 3.02 | 78.0 | 77.0 | 74.0 | 0.73 | 0.65 | 0.52 | 180 | 450 | 225 | 0.171 |
| 3.00 | 4.00 | ND132M | 8.2 | 7.8 | 7.5 | 710 | 4.12 | 79.0 | 73.0 | 66.0 | 0.70 | 0.66 | 0.60 | 170 | 450 | 225 | 0.200 |
| 3.70 | 5.00 | ND132M | 9.4 | 8.9 | 8.6 | 710 | 5.08 | 81.0 | 80.0 | 78.0 | 0.74 | 0.67 | 0.56 | 180 | 450 | 225 | 0.210 |
| 4.00 | 5.50 | ND160M | 11 | 10 | 9.6 | 710 | 5.49 | 82.5 | 81.0 | 80.0 | 0.70 | 0.68 | 0.60 | 200 | 450 | 250 | 0.400 |
| 5.50 | 7.50 | ND160M | 13 | 13 | 12 | 710 | 7.55 | 85.0 | 85.0 | 83.0 | 0.74 | 0.70 | 0.62 | 150 | 500 | 225 | 0.456 |
| 7.50 | 10.00 | ND160L | 18 | 17 | 16 | 710 | 10.29 | 85.0 | 85.0 | 83.0 | 0.76 | 0.72 | 0.64 | 150 | 500 | 225 | 0.636 |
| 9.30 | 12.50 | ND180M | 22 | 21 | 20 | 720 | 12.58 | 86.0 | 86.0 | 84.0 | 0.74 | 0.70 | 0.60 | 175 | 500 | 225 | 1.000 |
| 11.00 | 15.00 | ND180L | 26 | 25 | 24 | 720 | 14.88 | 87.0 | 87.0 | 85.0 | 0.74 | 0.70 | 0.60 | 175 | 500 | 225 | 1.160 |
| 15.00 | 20.00 | ND200L | 36 | 34 | 33 | 725 | 20.15 | 88.5 | 88.5 | 86.5 | 0.71 | 0.65 | 0.55 | 225 | 500 | 275 | 2.137 |
| 18.50 | 25.00 | ND225S | 42 | 40 | 39 | 725 | 24.85 | 89.0 | 89.0 | 87.0 | 0.75 | 0.71 | 0.63 | 175 | 500 | 225 | 3.238 |
| 22.00 | 30.00 | ND225M | 50 | 48 | 46 | 725 | 29.56 | 89.0 | 89.0 | 87.0 | 0.75 | 0.71 | 0.63 | 175 | 500 | 225 | 3.615 |
| 30.00 | 40.00 | ND250M | 67 | 63 | 61 | 735 | 39.76 | 91.0 | 90.5 | 88.5 | 0.75 | 0.71 | 0.63 | 175 | 550 | 225 | 4.712 |
| 37.00 | 50.00 | ND280S | 82 | 78 | 75 | 735 | 49.03 | 91.5 | 91.5 | 89.5 | 0.75 | 0.71 | 0.63 | 200 | 500 | 250 | 8.013 |
| 45.00 | 60.00 | ND280M | 99 | 94 | 91 | 725 | 60.46 | 92.0 | 92.0 | 90.5 | 0.75 | 0.71 | 0.63 | 175 | 500 | 225 | 8.639 |
| 55.00 | 75.00 | ND315S | 130 | 124 | 119 | 740 | 72.39 | 91.5 | 91.0 | 89.5 | 0.70 | 0.63 | 0.56 | 175 | 500 | 225 | 14.124 |
| 75.00 | 100.00 | ND315M | 165 | 156 | 151 | 740 | 98.72 | 93.5 | 93.5 | 91.5 | 0.74 | 0.70 | 0.60 | 200 | 500 | 250 | 16.993 |
| 90.00 | 120.00 | ND315L | 197 | 187 | 180 | 740 | 118.43 | 94.0 | 94.0 | 92.0 | 0.74 | 0.70 | 0.60 | 150 | 500 | 225 | 25.256 |
| 110.00 | 150.00 | ND315LX | 231 | 219 | 211 | 740 | 144.75 | 94.5 | 94.5 | 92.5 | 0.74 | 0.70 | 0.60 | 150 | 500 | 225 | 29.848 |
| 132.00 | 180.00 | ND315LX | 287 | 272 | 263 | 740 | 173.7 | 94.7 | 94.7 | 92.7 | 0.76 | 0.72 | 0.62 | 150 | 500 | 225 | 31.816 |
| 160.00 | 215.00 | ND355LX | 334 | 317 | 306 | 743 | 210.54 | 94.5 | 94.0 | 92.0 | 0.77 | 0.73 | 0.63 | 125 | 500 | 225 | 45.425 |
| 180.00 | 240.00 | ND355LX | 376 | 357 | 344 | 740 | 236.22 | 94.5 | 93.5 | 92.0 | 0.77 | 0.73 | 0.63 | 125 | 500 | 225 | 51.045 |
| 200.00 | 270.00 | ND355LX | 417 | 396 | 382 | 743 | 262.47 | 94.7 | 94.5 | 92.5 | 0.77 | 0.73 | 0.63 | 125 | 400 | 225 | 58.069 |

* Tolerances are applicable as per IEC 60034-2004

Full load current indicated are given for respective voltage designs

NOTE : As the design and manufacture of Crompton Greaves electrical equipment are subject to constant improvement ,the product supplied may differ in some details from the specifications and illustrations given in this booklet. For more details ,contact CG Sales.

Bearing Details



| Bearings | | | |
|----------|------|-------------|-----------------|
| Frame | Pole | Driving End | Non-Driving End |

ALUMINIUM MOTORS

| | | | |
|---------|---------|-----------|-----------|
| GD63 | 2,4,6 | 6202ZZ | 6202ZZ |
| GD71 | 2,4,6 | 6003ZZ | 6003ZZ |
| GD80M | 2,4,6,8 | 6204ZZ | 6003ZZ |
| GD90S/L | 2,4,6,8 | 6205ZZ-C3 | 6203ZZ |
| GD100L | 2,4,6,8 | 6206ZZ-C3 | 6205ZZ-C3 |
| GD112M | 2,4,6,8 | 6206ZZ-C3 | 6205ZZ-C3 |
| GD132S | 2,4,6,8 | 6208ZZ-C3 | 6305ZZ-C3 |

CAST IRON MOTORS

| | | | |
|-----------|---------|----------|----------|
| ND80 | 2,4,6 | 6204ZZ | 6204ZZ |
| ND90S/L | 2,4,6,8 | 6205ZZ | 6205ZZ |
| ND100L | 2,4,6,8 | 6206ZZ | 6205ZZ |
| ND112M | 2,4,6,8 | 6306ZZ | 6205ZZ |
| ND132S | 2,4,6 | 6306ZZ | 6205ZZ |
| ND132S/M | 2,4,6,8 | 6308ZZ | 6208ZZ |
| ND160M/L | 2,4,6,8 | 6309-2RS | 6209-2RS |
| ND180L | 2,4,6,8 | 6310-2RS | 6210-2RS |
| ND200L | 2,4,6,8 | 6312-2RS | 6212-2RS |
| ND225M | 2,4,6,8 | 6313-2RS | 6213-2RS |
| ND250M | 4,6,8 | 6314-C3 | 6314-C3 |
| ND250M | 2 | 6314-C4 | 6314-C4 |
| ND280S/M | 2 | 6314-C4 | 6314-C4 |
| ND280S/M | 4,6,8 | 6318-C3 | 6318-C3 |
| ND315S/M | 2 | 6315-C4 | 6315-C4 |
| ND315S/M | 4,6,8 | 6319-C3 | 6319-C3 |
| ND315L/LX | 2 | 6315-C4 | 6315-C4 |
| ND315L/LX | 4,6,8 | 6319-C3 | 6319-C3 |
| ND355L/LX | 2 | 6316-C4 | 6316-C4 |
| ND355L/LX | 4,6,8 | 6322-C3 | 6322-C3 |

Approximate shipping dimensions & Weights

| FRAME | kg | |
|------------------|--------|-------|
| | NET WT | GR WT |
| ALUMINIUM | | |
| GD80 | 9 | 10 |
| GD90S | 13 | 14 |
| GD90L | 15 | 16 |
| GD100L | 27 | 29 |
| GD112M | 33 | 36 |
| GD132S | 54 | 56 |
| GD132M | 54 | 56 |

CAST IRON

| | | |
|---------|------|------|
| ND80 | 17 | 21 |
| ND90S | 22 | 26 |
| ND90L | 25 | 29 |
| ND100L | 32 | 37 |
| ND112M | 35 | 40 |
| ND132M | 79 | 89 |
| ND160M | 121 | 151 |
| ND160L | 143 | 173 |
| ND180M | 174 | 208 |
| ND180L | 204 | 238 |
| ND200L | 254 | 291 |
| ND225S | 350 | 430 |
| ND225M | 380 | 460 |
| ND250M | 500 | 575 |
| ND280S | 620 | 761 |
| ND280M | 700 | 841 |
| ND315S | 900 | 1020 |
| ND315M | 950 | 1070 |
| ND315L | 1200 | 1480 |
| ND355L | 1500 | 1800 |
| ND355LX | 2020 | 2425 |

Packing case details

| Packing case | | |
|--------------|----------------|-------------------|
| Frame | L X B X H | Packing case type |
| 63 | 295X190X230 | Carton |
| 71 | 295X190X230 | Carton |
| 80 | 360X225X240 | Carton |
| 90 | 390X220X260 | Carton |
| 100 | 460X320X285 | Carton |
| 112 | 460X320X285 | Carton |
| 132 | 485X350X320 | Carton |
| 160 | 800X585X615 | Wooden |
| 180 | 900X685X640 | Wooden |
| 200 | 1000X775X665 | Wooden |
| 225 | 1050X800X725 | Wooden |
| 250 | 1150X925X850 | Wooden |
| 280 | 1250X975X890 | Wooden |
| 315 | 1620X1170X1030 | Wooden |
| 355 | 1870X1345X1180 | Wooden |

NOTE: - Insulated bearing and Rollers bearings for frame 200 & above are available on request

*Shipping details may vary at the time of execution of order.

Noise Limits (IEC 60034-9) - 2007

Maximum A-weighted sound power level ,in dB ,at no-load
(For single speed three-phase Squirrel cage induction motor IC411)

| Shaft height. H mm | 2 pole | 4 pole | 6 pole | 8 pole |
|--------------------------|--------|--------|--------|--------|
| 90 | 78 | 66 | 63 | 63 |
| 100 | 82 | 70 | 64 | 64 |
| 112 | 83 | 72 | 70 | 70 |
| 132 | 85 | 75 | 73 | 71 |
| 160 | 87 | 77 | 73 | 72 |
| 180 | 88 | 80 | 77 | 76 |
| 200 | 90 | 83 | 80 | 79 |
| 225 | 92 | 84 | 80 | 79 |
| 250 | 92 | 85 | 82 | 80 |
| 280 | 94 | 88 | 85 | 82 |
| 315 | 98 | 94 | 89 | 88 |
| 355 | 100 | 95 | 94 | 92 |

MOUNTING ARRANGMENTS (IEC 60034-7)

| HORIZONTAL | | |
|------------|-----------------------|---------------|
| FIGURE | | |
| REF | B3 | B5 |
| FRAME | WITH FEET | WITHOUT FEET |
| SHAFT | HORIZONTAL | HORIZONTAL |
| MTNG | BASE OR RAILS | FLANGE TYPE D |
| FIGURE | | |
| REF | B35 | B14 |
| FRAME | WITH FEET & FLANGE | WITHOUT FEET |
| SHAFT | HORIZONTAL | HORIZONTAL |
| MTNG | BASE OR FLANGE TYPE D | FLANGE TYPE C |
| FIGURE | | |
| REF | B34 | B6 |
| FRAME | WITH FEET | WITH FEET |
| SHAFT | HORIZONTAL | HORIZONTAL |
| MTNG | BASE OR FLANGE TYPE C | WALL |
| FIGURE | | |
| REF | B7 | B8 |
| FRAME | WITH FEET | WITH FEET |
| SHAFT | HORIZONTAL | HORIZONTAL |
| MTNG | WALL | CEILING |

| VERTICAL | | |
|----------|-----------------------|----------------|
| FIGURE | | |
| REF | V1 | V5 |
| FRAME | WITHOUT FEET | WITH FEET |
| SHAFT | FACE VERT.DOWN | FACE VERT.DOWN |
| MTNG | FLANGE TYPE D | BASE OR RAILS |
| FIGURE | | |
| REF | V15 | V3 |
| FRAME | WITH FEET | WITHOUT FEET |
| SHAFT | FACE VERT.DOWN | FACE VERT.UP |
| MTNG | WALL OR FLANGE TYPE D | FLANGE TYPE D |
| FIGURE | | |
| REF | V36 | V6 |
| FRAME | WITH FEET | WITH FEET |
| SHAFT | FACE VERT.UP | FACE VERT.UP |
| MTNG | WALL OR FLANGE TYPE D | BASE OR RAILS |
| FIGURE | | |
| REF | V18 | V19 |
| FRAME | WITHOUT FEET | WITHOUT FEET |
| SHAFT | FACE VERT.DOWN | FACE VERT.UP |
| MTNG | FLANGE TYPE C | FLANGE TYPE C |

Save Energy ...

Save Money ...

Save Environment ...



NOTES:

A series of horizontal dashed lines for writing notes.

NOTES:

A series of horizontal dashed lines for writing notes.

ONE CG.

From generator to bulb, all across the globe

POWER — AUTOMATION

INDUSTRIAL CONSUMER

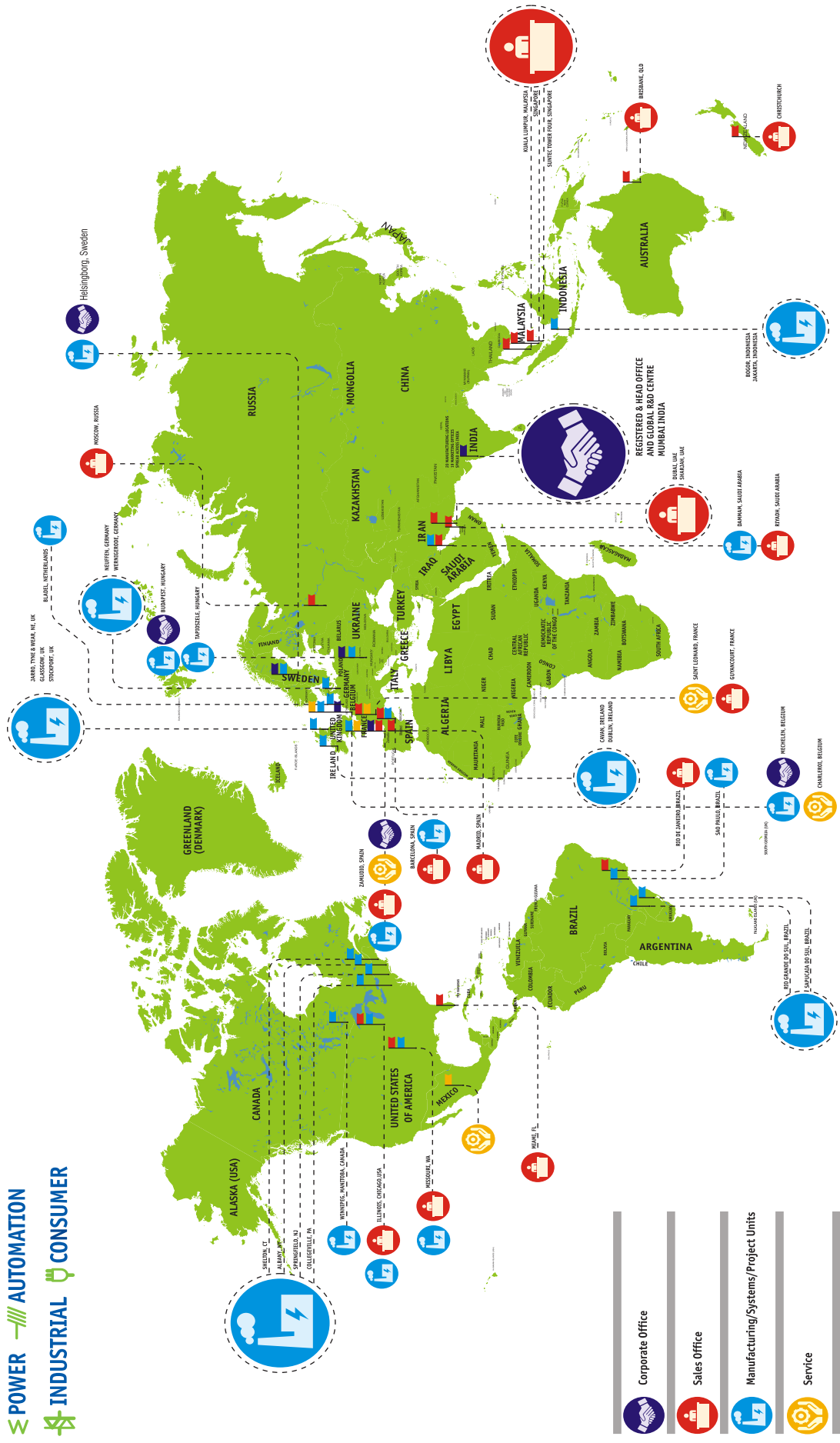

- Corporate Office
- Sales Office
- Manufacturing/Systems/Project Units
- Service

For more information :

Visit us at : www.cgglobal.com